

T.4 S., R. 3 W., W.M.

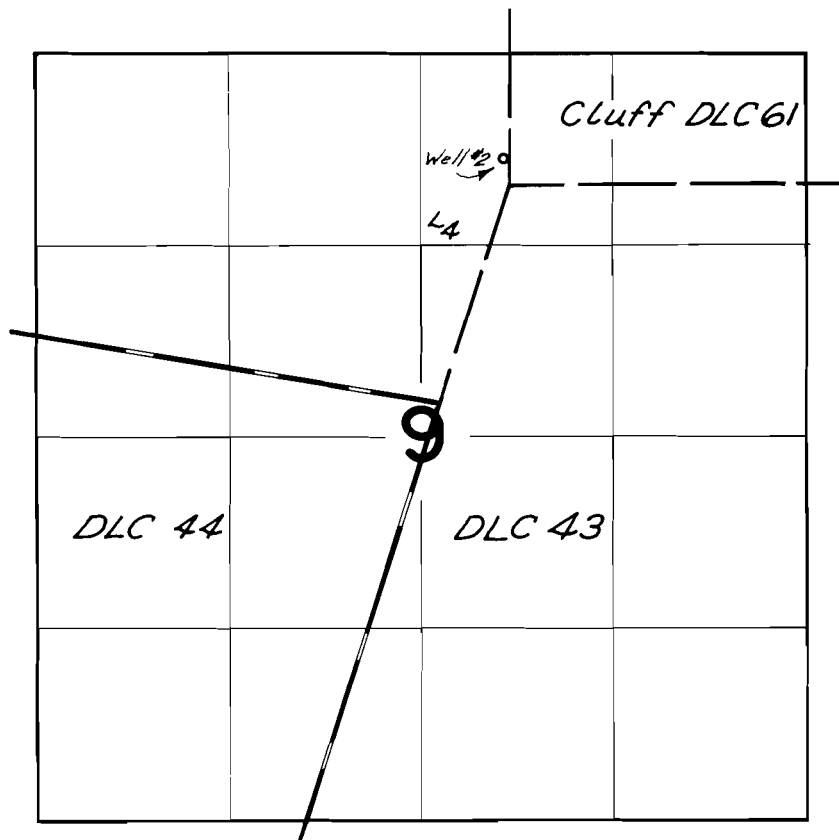

Well #2 Loc.: 200 ft. N. & 20 ft. E. from SW Cor. DLC 61

FINAL PROOF SURVEY UNDER

Application No. G-5646 Permit No. G-5466
IN NAME OF

City of Dayton

Surveyed Apr. 1, 1976, by L. H. Nunn

DFQ-2LL-213 & 215 a/cb