

T. 5S. R. 7W. W.M.

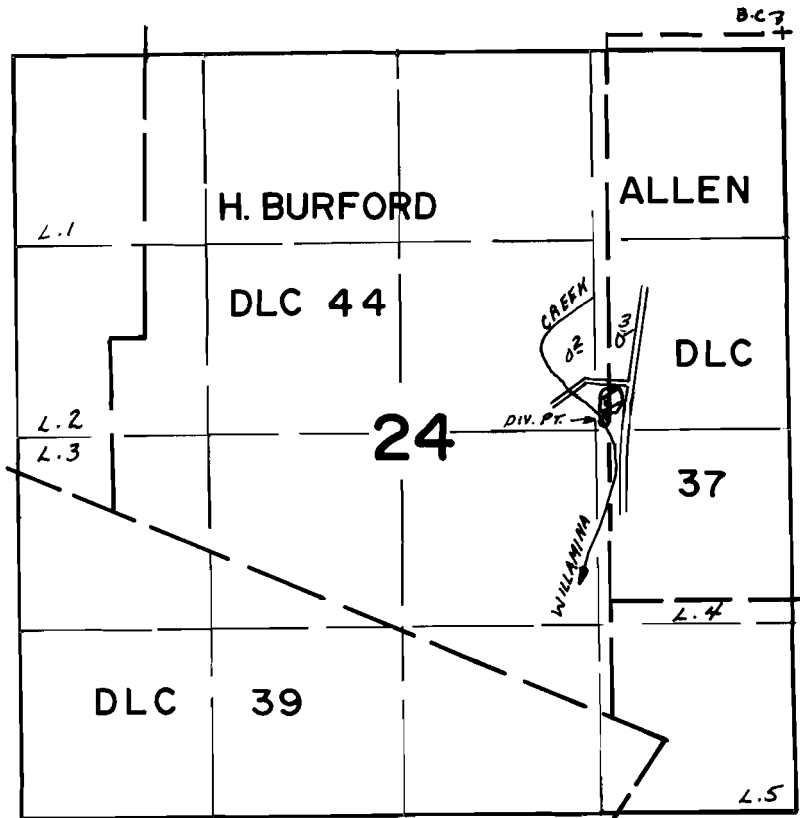

DIV. PT. LOC. - 50' N 1/2 1275' W FROM E 1/4 COR. SEC. 24

FINAL PROOF SURVEY
UNDER

Application No. 53206. Permit No. 39482.
IN NAME OF

PETER N. OHRT

Surveyed May 14, 1976, by L.H. NUNN