

T.13&14S. R.4W. W.M.

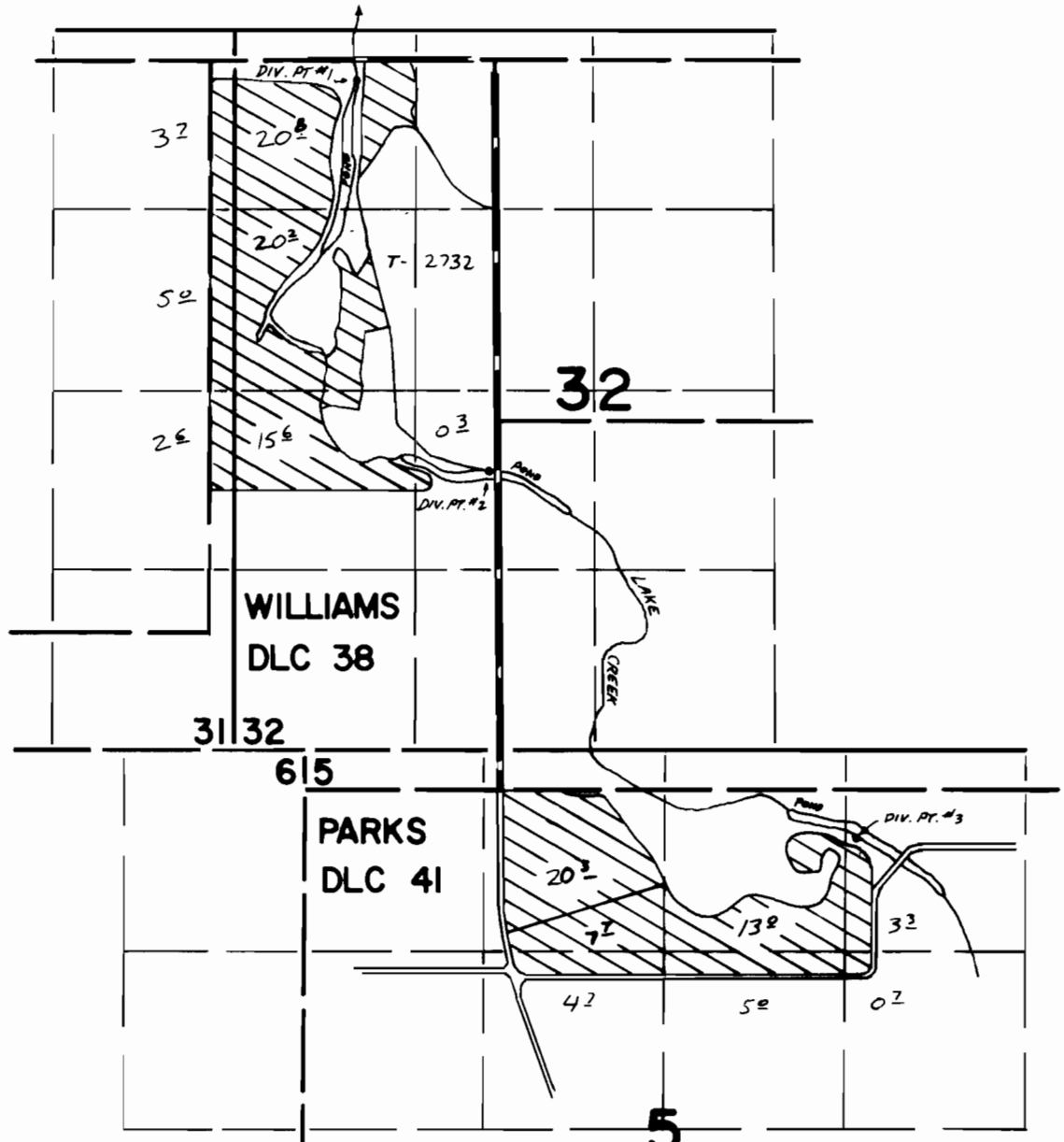

DIV. PT. #1 LOCATED 170'S & 1030' WY FROM THE NE COR WILLIAMS DLC 38
 DIV. PT. #2 LOCATED 3040'S & 60' W FROM THE NE COR WILLIAMS DLC 38
 DIV. PT. #3 LOCATED 630'S & 2590' E FROM THE SE COR WILLIAMS DLC 38

FINAL PROOF SURVEY UNDER

Application No. 28443..... Permit No. 27839.....
 IN NAME OF

.....JOHN W. & BESSIE N. MILLER.....

Surveyed MAY...7.... 1976., by R..G. MUCKEN.....