

T.22S., R.46E., W.M.

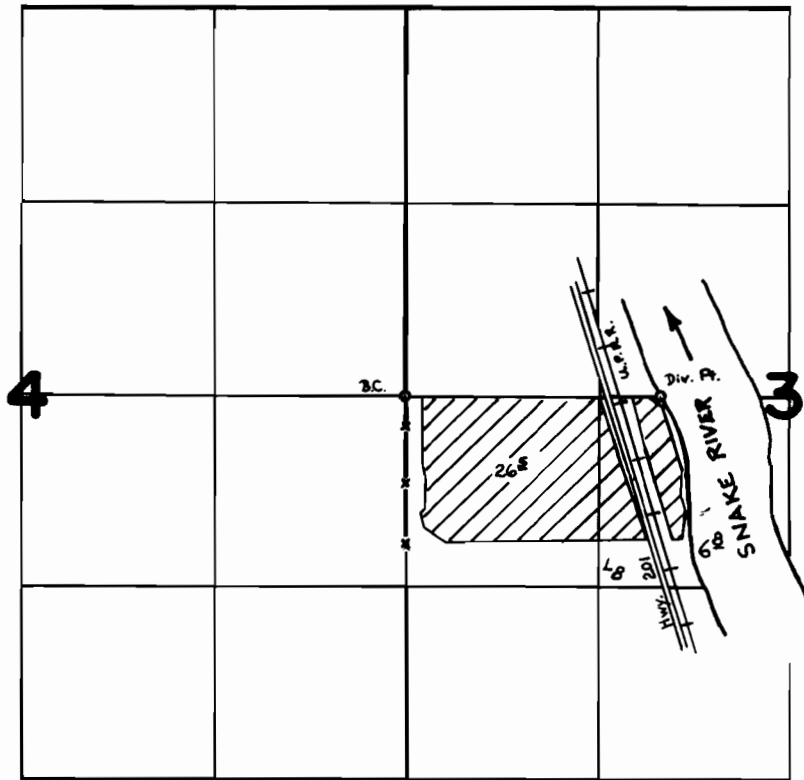

Div. Pt. Located: 1750' E from W 1/4 cor. Sec. 3

**FINAL PROOF SURVEY**  
UNDER

Application No. 49945 Permit No. 37154  
IN NAME OF

..... KEITH L. SMITH .....

Surveyed OCT. 18, 1977, by J.S. DONALDSON.