

G-6540

T.1S. R.17E. W.M.

N.1/4 COR.
SEC 19

WELL LOC. 475'S + 665'W. FROM N. 1/4 COR. SEC. 19
SCALE 1" = 200'

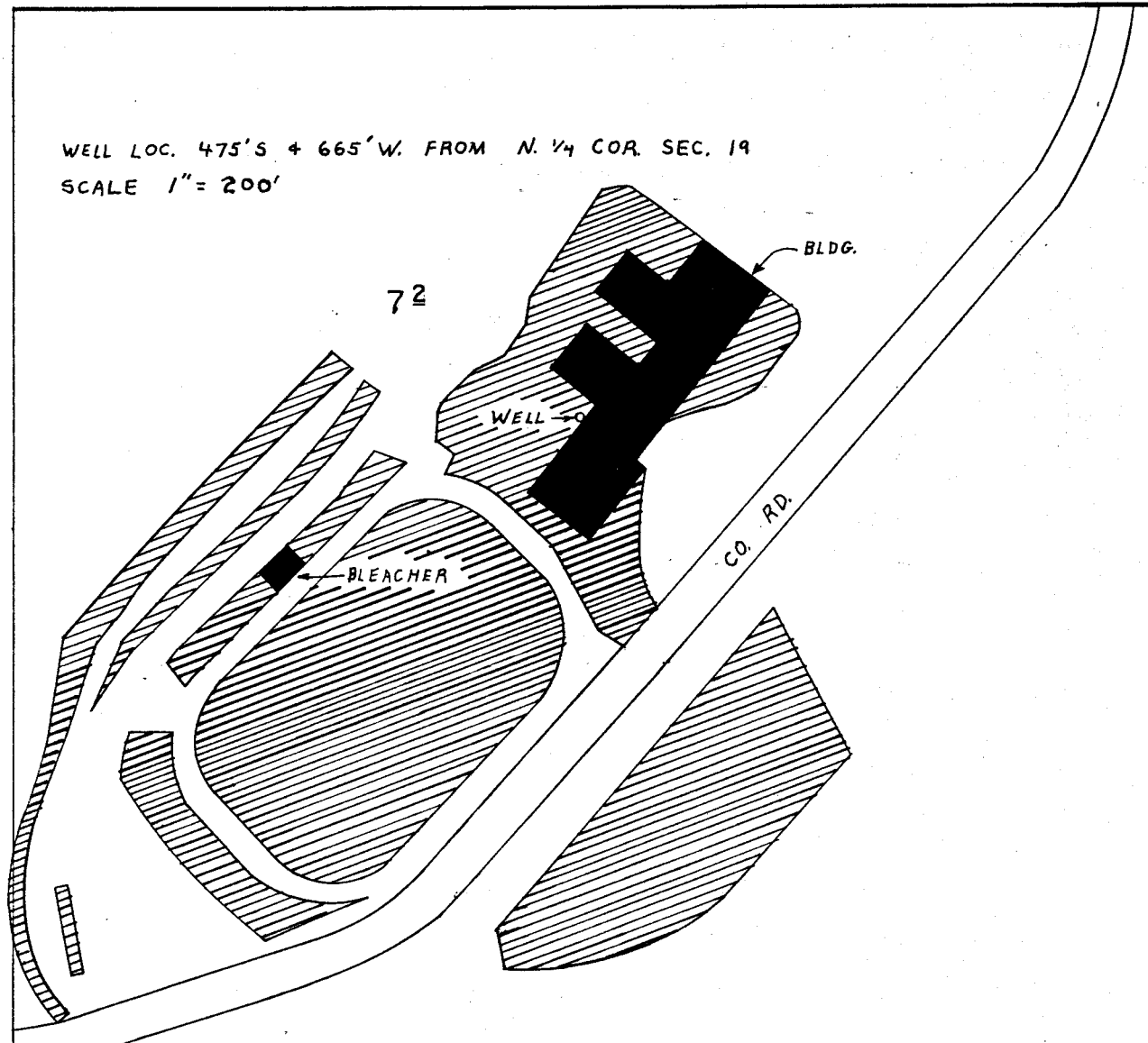

FINAL PROOF SURVEY UNDER

Application No. G-7057 Permit No. G-6540 - C-47321
IN NAME OF

SHERMAN UNION HIGH SCHOOL DISTRICT NO. UH I

Surveyed OCT. 27, 1977, by B.G. MUCKEN.....