

T.1N.R.48E.W.M.

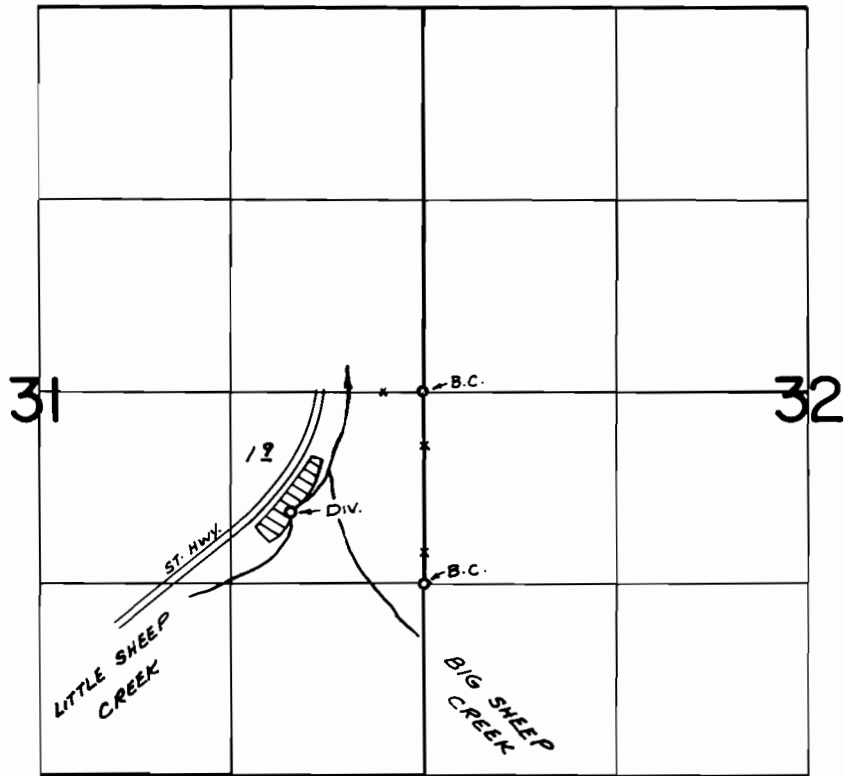

DIV. LOC: 820'S. & 920'W. FROM E 1/4 COR. SEC. 31

**FINAL PROOF SURVEY**  
UNDER

Application No. *50830* Permit No. *38377*  
IN NAME OF

.....*NORRIS E. EVANS*.....

Surveyed *SEPT. 24, 1976*, by *R. MUCKEN*