

# T.2S.R.45E.W.M.

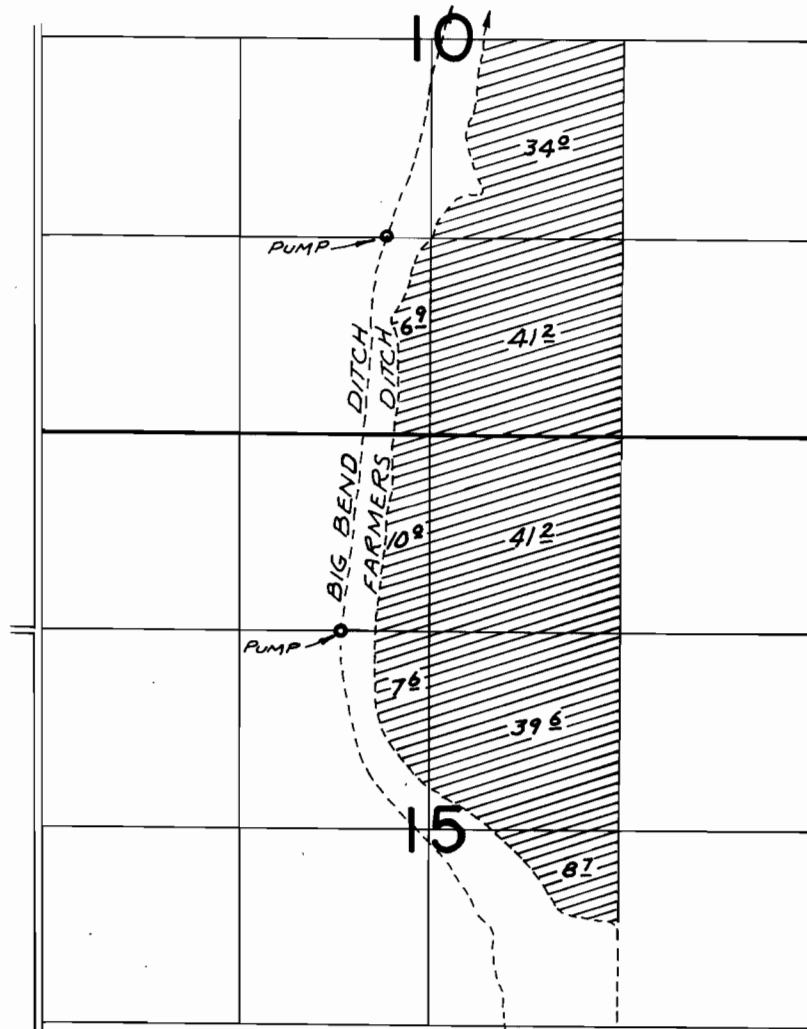

DIV. LOC: 550'S. & 800'W. FROM NE. COR. SEC. 31

## FINAL PROOF SURVEY UNDER

Application No. 51724 Permit No. 38986  
IN NAME OF

JIM PETTY

Surveyed SEPT. 28 1976, by R. MUGKEN