

T. 3 S., R. 2 E., W.M.

SECTION 26

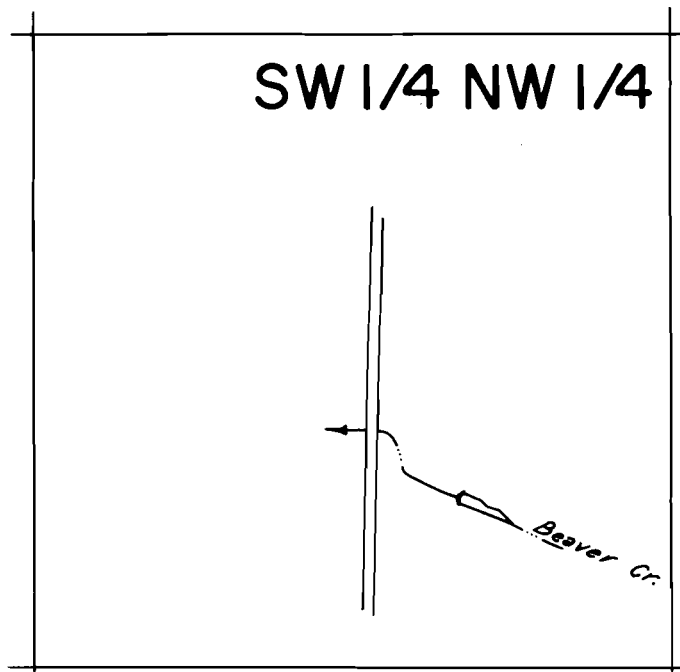

Dam Loc.: 950' N. & 1760' W., from Center
Section 26

SCALE 1" = 400'

FINAL PROOF SURVEY
UNDER

R-53338 *R-6334*
Application No. 53339 Permit No. 39574
IN NAME OF

John B. Haggemiller

Surveyed *Aug 3, 1977*, by *dCBrown*

PTS-1977-L