

# T.7N.R.4W.W.M.

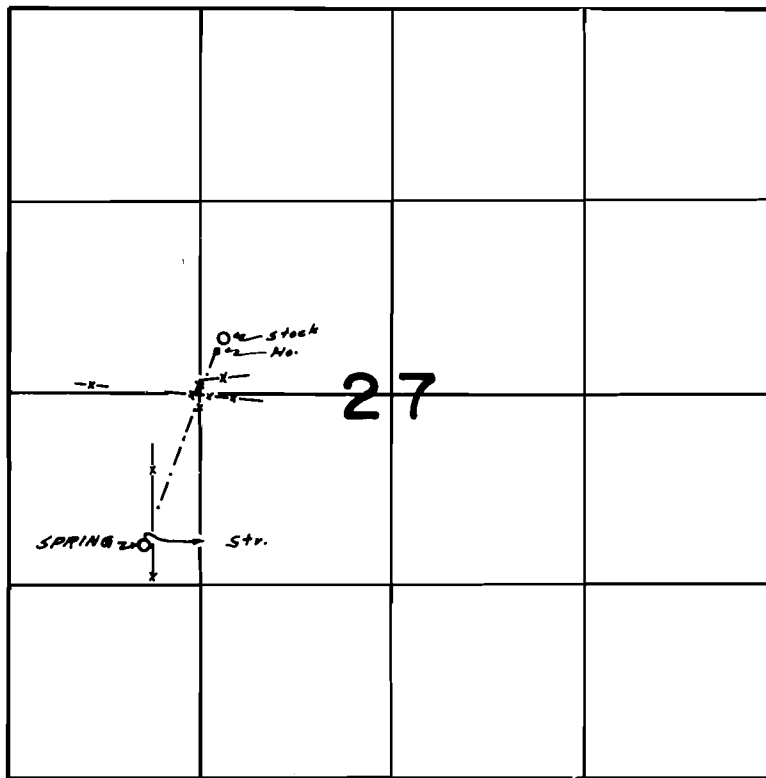

SPRING LOC. - 1050'S + 970'E from W Cor. Sec. 27

## FINAL PROOF SURVEY UNDER

Application No. 53848. Permit No. 40188...  
IN NAME OF

..... DANIEL E. WESTLIND .....

Surveyed ..8..18.. 1977, by S.C.BROWN.....