

T.28&29S., R.13W., W.M.

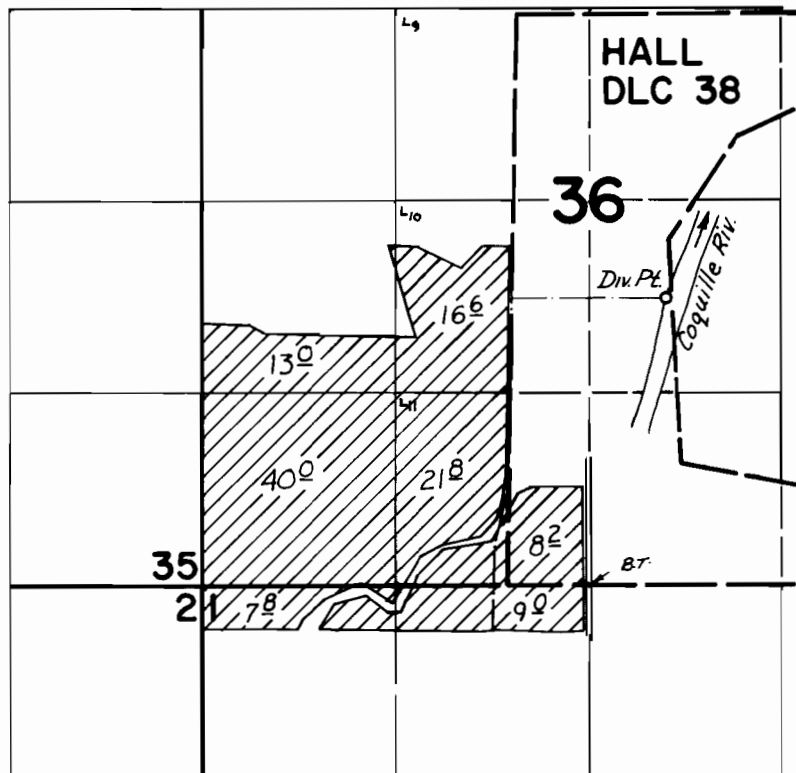

DIV. PT. LOC: 1970' N & 1050' E FROM SW COR. HALL DLC 38

FINAL PROOF SURVEY
UNDER

Application No. 45019 Permit No. 33649
IN NAME OF

PAUL D. &/OR ANGELA S. ORCHARD

Surveyed July 21, 1976, by D. Norby