

T.6S.,R.6W.,W.M.

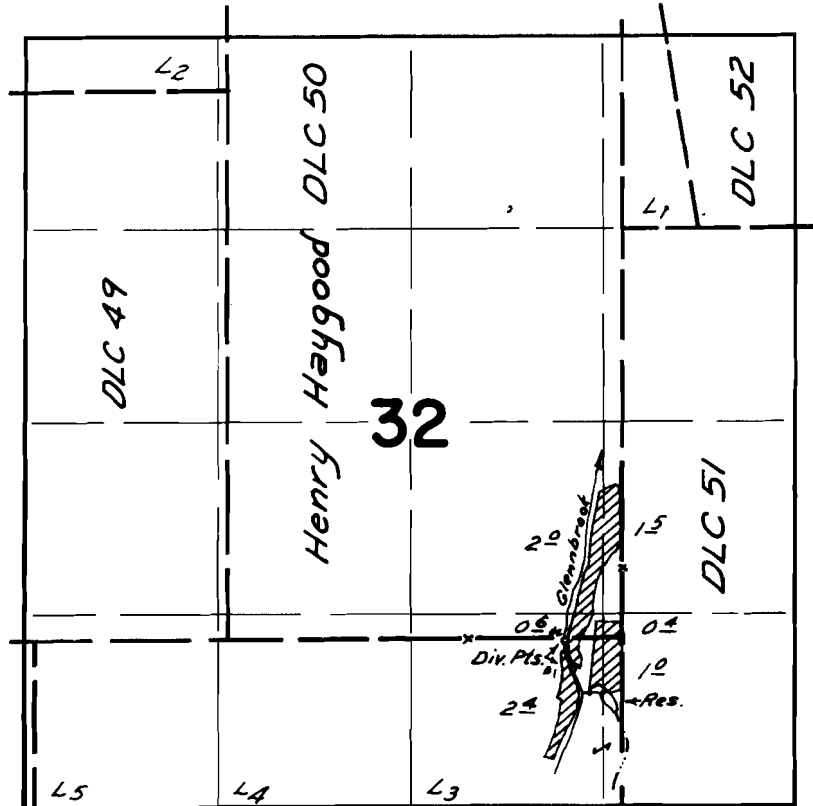

DIV. PT. LOC: No.1-950' N. & 1520' W.; No.2-1130' N. & 1570' W.; RESERVOIR-750' N. & 1320' W., ALL FROM SE COR. SEC. 32.

FINAL PROOF SURVEY UNDER

R-50729 R-6021
Application No. 50730 Permit No. 37110
IN NAME OF

Glenn Moore

Surveyed Apr. 18, 1975 by L. H. Nunn