

T.1S. R.4W. W.M.

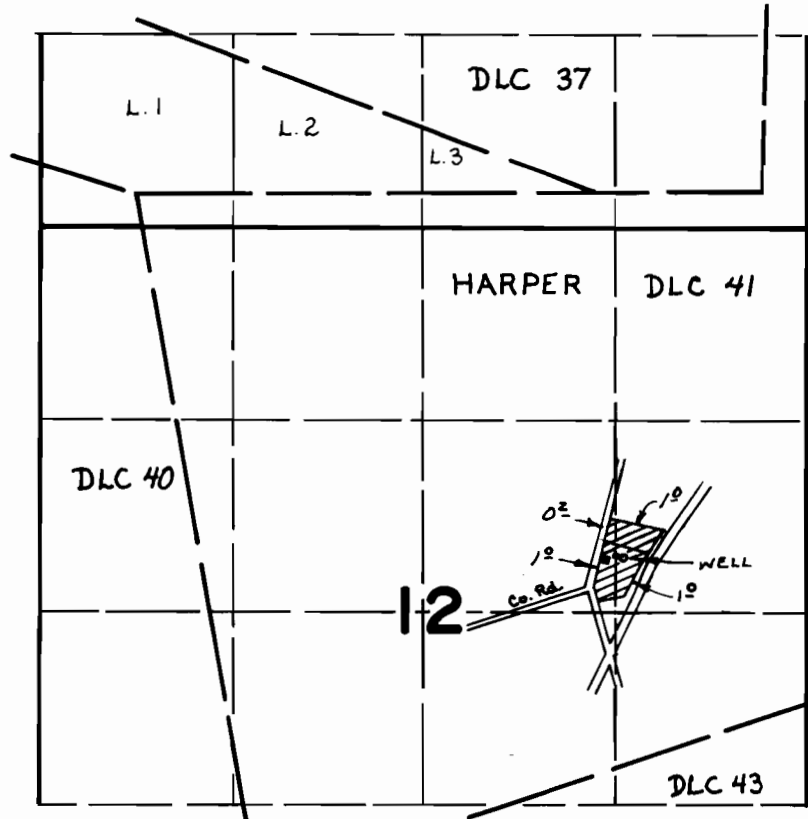

Well Located: 375' N & 50' E from SW cor. SE 1/4 NE 1/4 Sec. 12

FINAL PROOF SURVEY UNDER

Application No. G-7074 Permit No. G-6548
IN NAME OF

MARION PEABODY

Surveyed OCT. 31, 1977., by J.S. DONALDSON.