

T.4 S., R. 3 E., W.M.

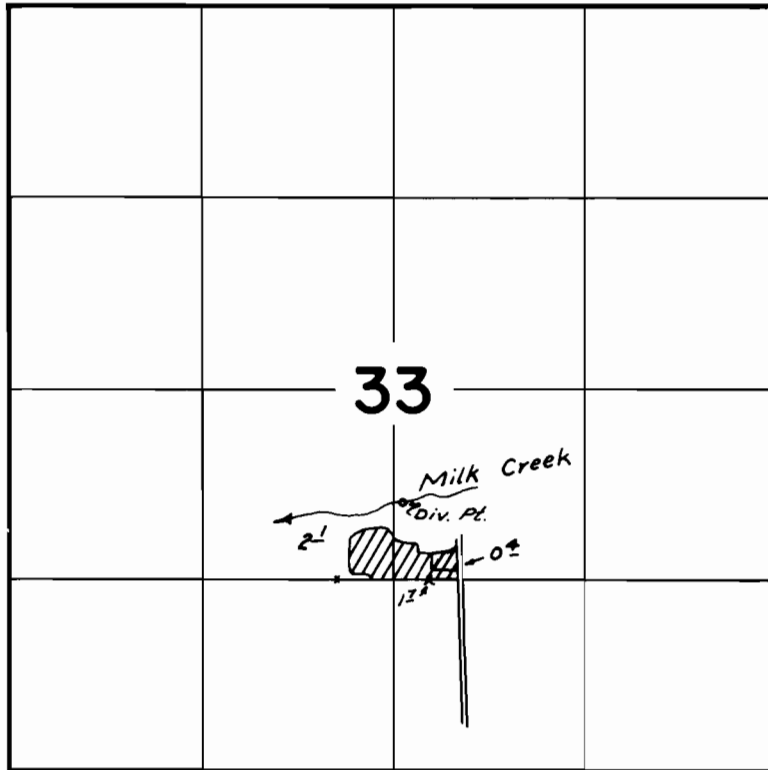

Div. Pt. Loc.: 780' S. & 60' E from ctr.  $\frac{1}{4}$  Cor. Sec. 33

**FINAL PROOF SURVEY**  
UNDER

Application No. 51507 Permit No. 38873  
IN NAME OF

A. J. Wallaert

Surveyed July 27, 1977 by dCBrown