

P-36620  
C-47507

# T.13S. R.31E. W.M.

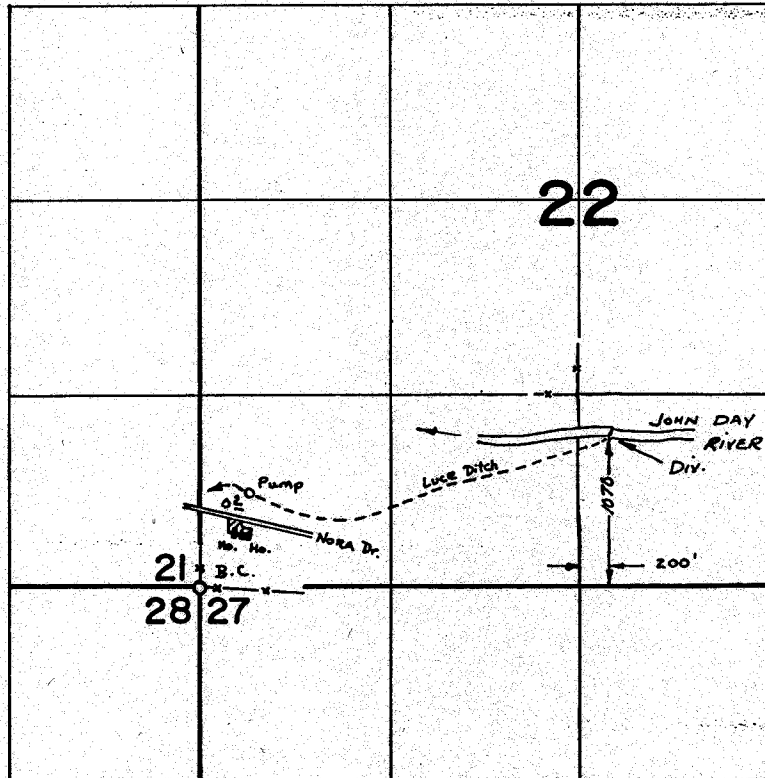

Div. Pt. LOCATED: 1070' N. & 200' E. FROM S  $\frac{1}{4}$  COR. SEC. 22

## FINAL PROOF SURVEY UNDER

Application No. 48874. Permit No. 36620  
IN NAME OF

RAY C. & GERTRUDE M. WELDIN.

Surveyed SEPT. 19, 1977, by S. BROWN