

P- 39651
47509

T.13 S. R.31 E. W.M.

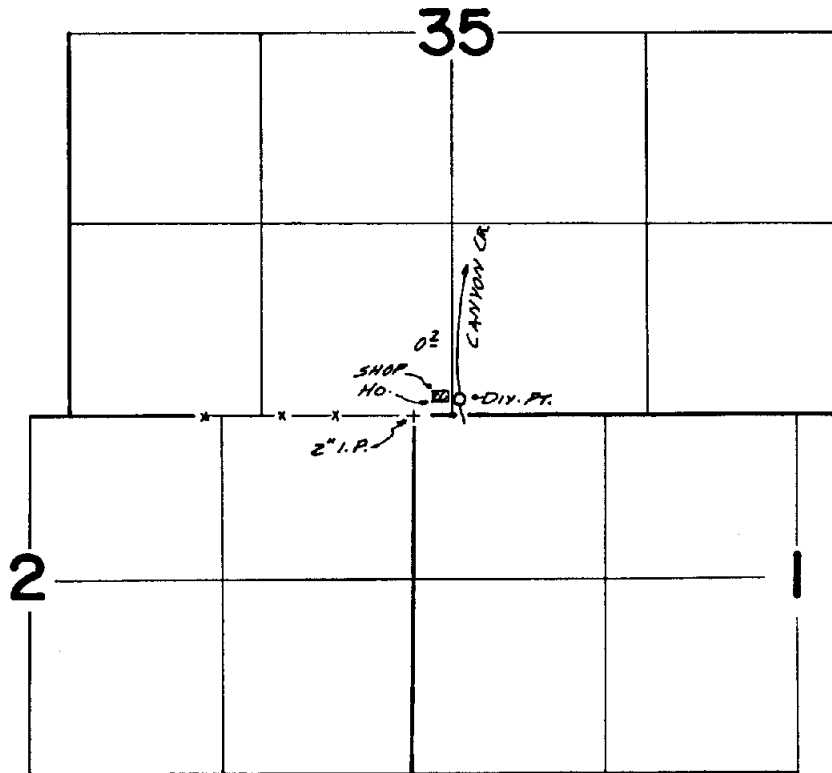

DIV. PT. LOC. 150' N & 40' E FROM 5/4 COR. SEC. 35

FINAL PROOF SURVEY UNDER

Application No. 52554 Permit No. 39651 C-47509
IN NAME OF

HOWARD R. & MARY E. DEIST

Surveyed Sept. 15, 1977, by S.C. BROWN