

T.1S.R.8W. W.M.

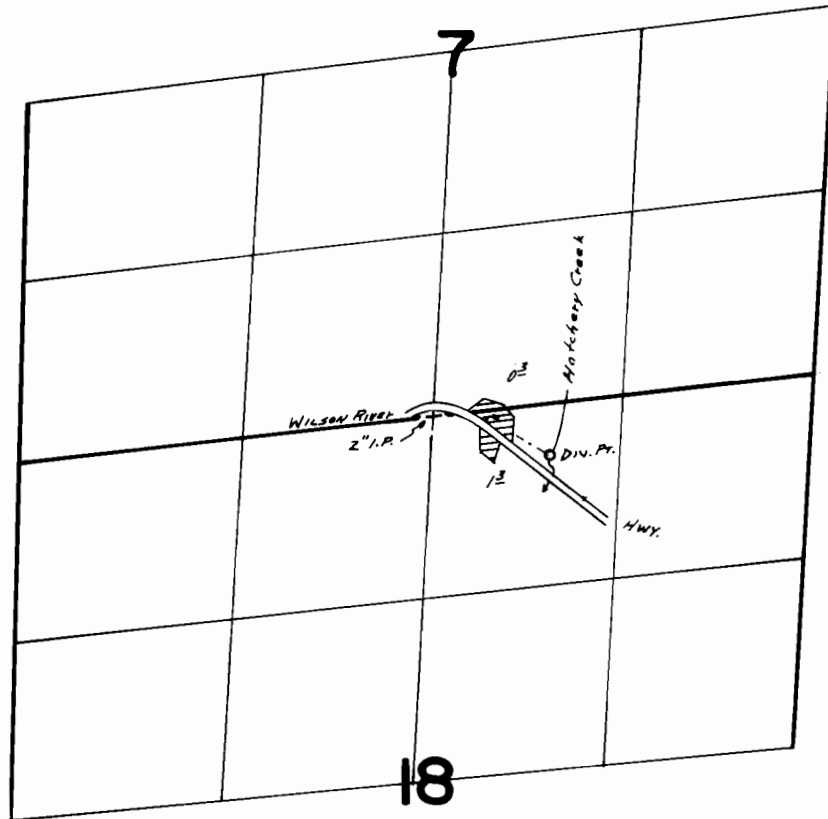

Div. Pt. Loc. 350' S & 800' E From N¹/₄ Cor. Sec. 18

FINAL PROOF SURVEY UNDER

Application No. 49592.. Permit No. 37.215...
IN NAME OF

..... JUNE MOYER

Surveyed ..Sept. 27 1977., by ..S.C. BROWN.....