

T3N. R9W. WM.

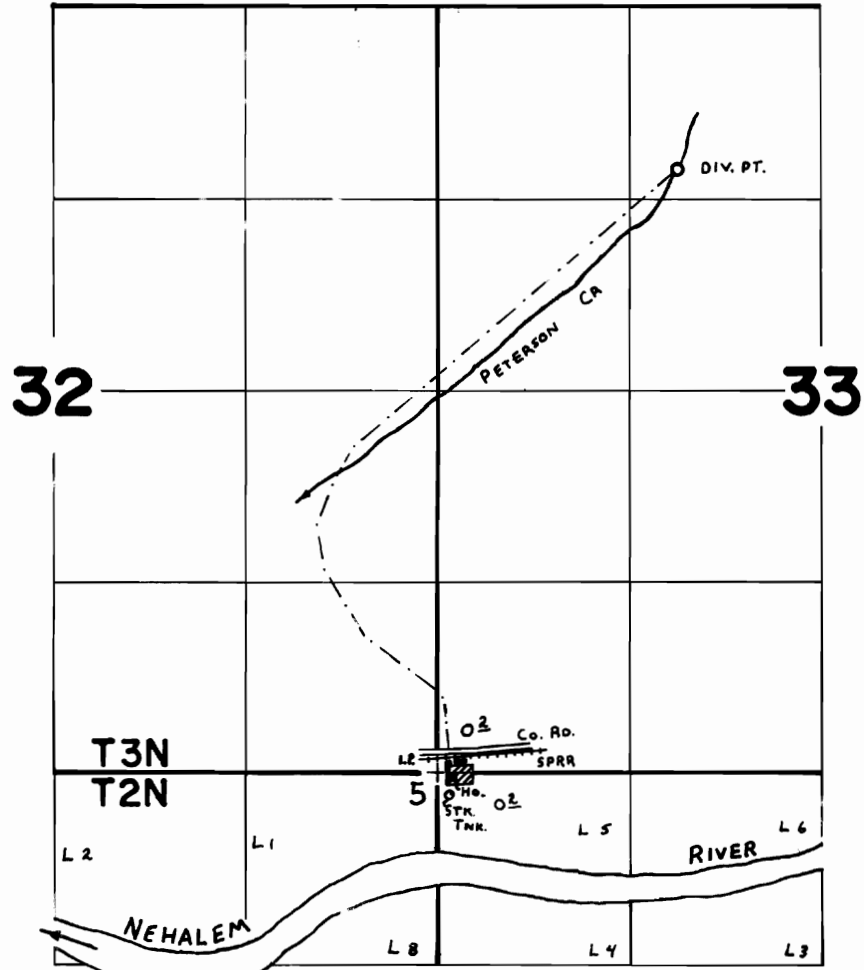

Div. Pt. Loc: 1130' S. & 980' W. fr. N. 1/4 Cor. Sec. 33.

FINAL PROOF SURVEY UNDER

TRANSFER 3898
Application No. _____ Permit No. _____
IN NAME OF

BOB FORSTER

Surveyed SEPT. 13 1978, by C. L. HUGHES