

T.2N.,R.33E.,W.M.

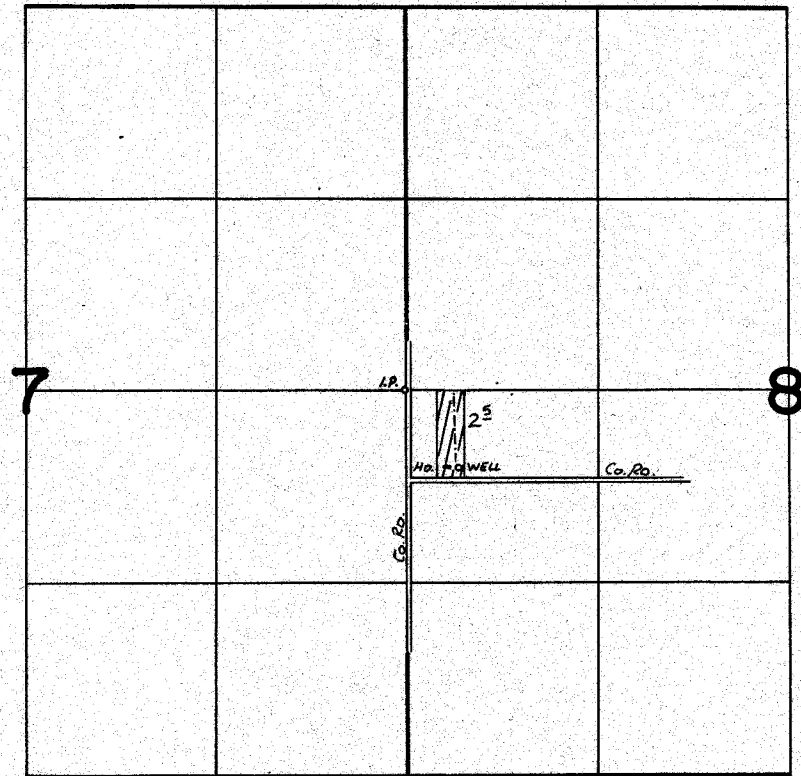

WELL Loc: 530' S AND 360' E FROM W'4 COR. SEC. 8

FINAL PROOF SURVEY UNDER

Application No. G-5676. Permit No. G-5033.
IN NAME OF

CLINTON & LETA FANNING

Surveyed APRIL 12, 1976, by L. Toll