

T.2N. R.5W. W.M.

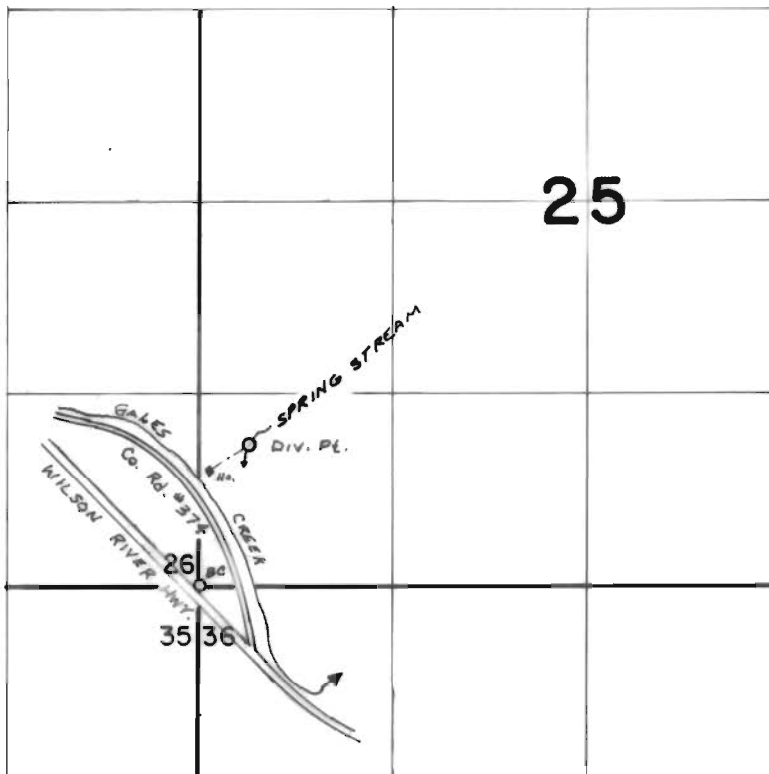

Div. Pt. 980' N. & 350' E from SW Cor. Sec. 25

FINAL PROOF SURVEY
UNDER

Application No. 52.84.9... Permit No. 39.89.2....
IN NAME OF

.....**T. A. SCHNEIDER**.....

Surveyed Oct. 6, 1977., by S. C. BROWN.....