

T.4N.R.2W. W.M.

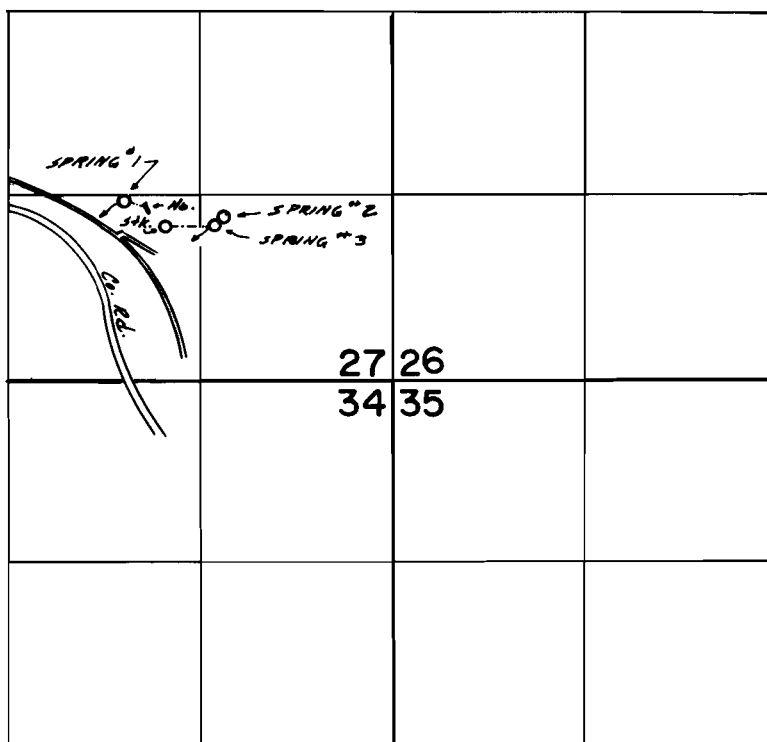

SPRINGS LOC. #1 - 50'S ± 800'E } All From NW Cor. SW 1/4 SE 1/4 Sec. 27
 #2 - 140'S ± 1460'E }
 #3 - 200'S ± 1400'E }

FINAL PROOF SURVEY UNDER

Application No. 53847. Permit No. 40392.
IN NAME OF

.....WILLIAM M. COFFMAN.....

Surveyed Aug. 11, 1977, by S.C. BROWN.....