

VICINITY MAP

SCALE: 1" = 2 MILES

I, A.L. Moore of Weyerhaeuser Company do hereby certify that this map was made from notes taken during an actual survey made under my immediate supervision on July 27, 1904 that the monument shown on this map pertaining to Basil Hall's existing well casing is 45.1 ft. N. 20° 30' E. of SE Section corner Section 25, T. 36S., R. 15E.

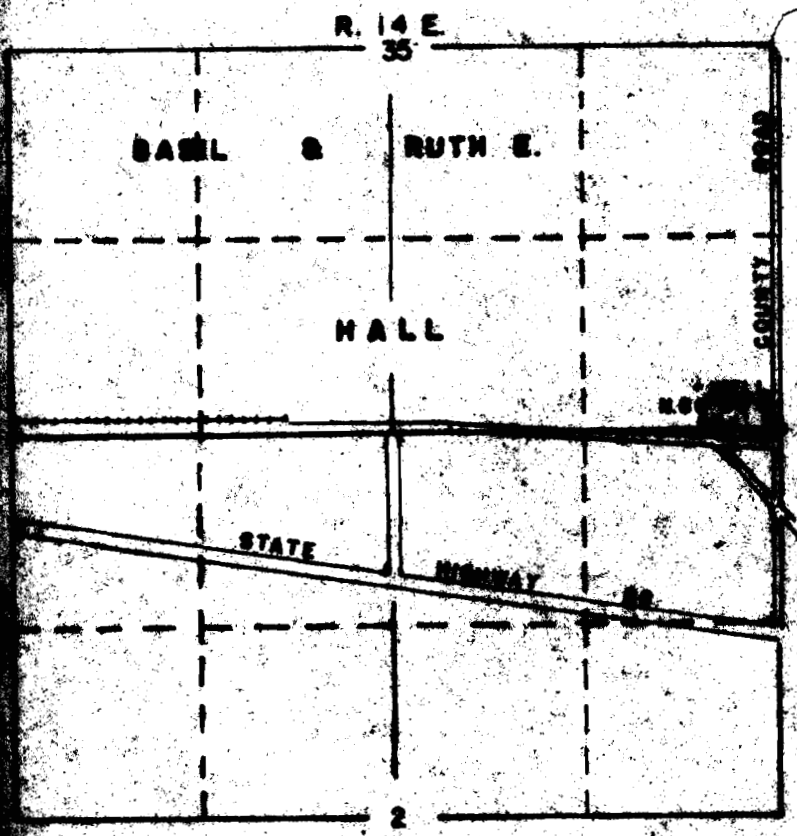

G-1964

SCALE: 4" = 1 MILE

REGISTERED  
**OFFICE**  
 LAND SURVEYOR  
*A. L. Moore*  
 NOV. 18, 1964  
 A. L. MOORE  
 47

Application No. G-2122  
 Map No. G-1964

WATER RIGHTS APPLICATION	
T. 36 & 37 S., R. 14 & 15 E., W.M.	
WEYERHAEUSER COMPANY	
LUMBER & PLYWOOD DIVISION	
KLANATH FALLS BRANCH	
SCALE - AS SHOWN	DATE - NOV. 1, 1961
DEL. - C.A.C.	CHECKED BY -
TRACED - C.A.C.	DRAWING NO. - K203-6