

G-6696
47618
T9673

T.25S. R.14E., W.M.

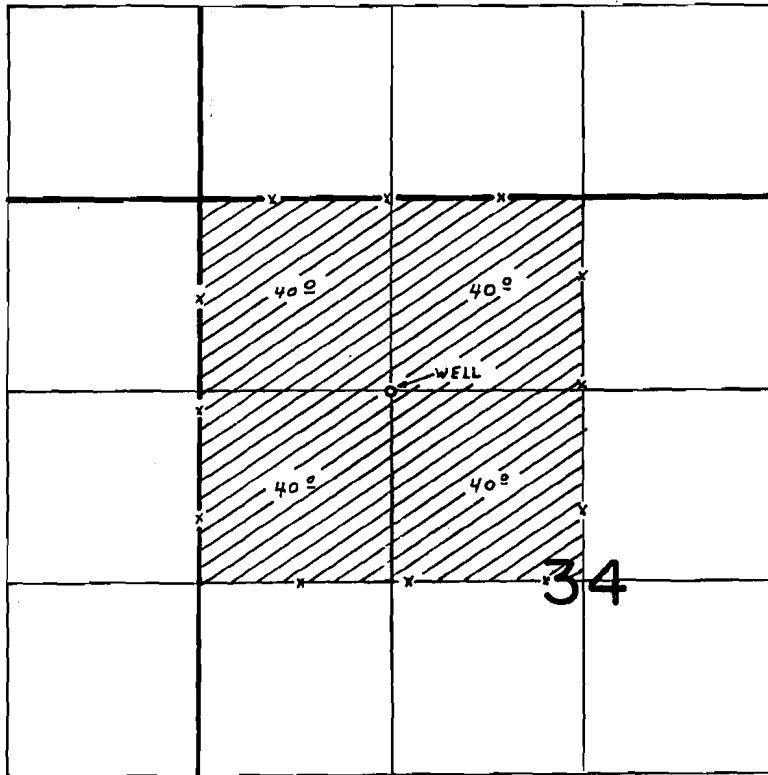

WELL LOC. 1320'S. & 1320'E. FROM N.W. COR. SEC. 34

FINAL PROOF SURVEY
UNDER

Application No. G-7127... Permit No. G-6696..
IN NAME OF

.....CHARLES & ILENE TOMPKINS.....

Surveyed JUL 18, 1977, by D.M. NORBY.....