

T.6S. R.3W.,W.M.

NW SW SEC 24

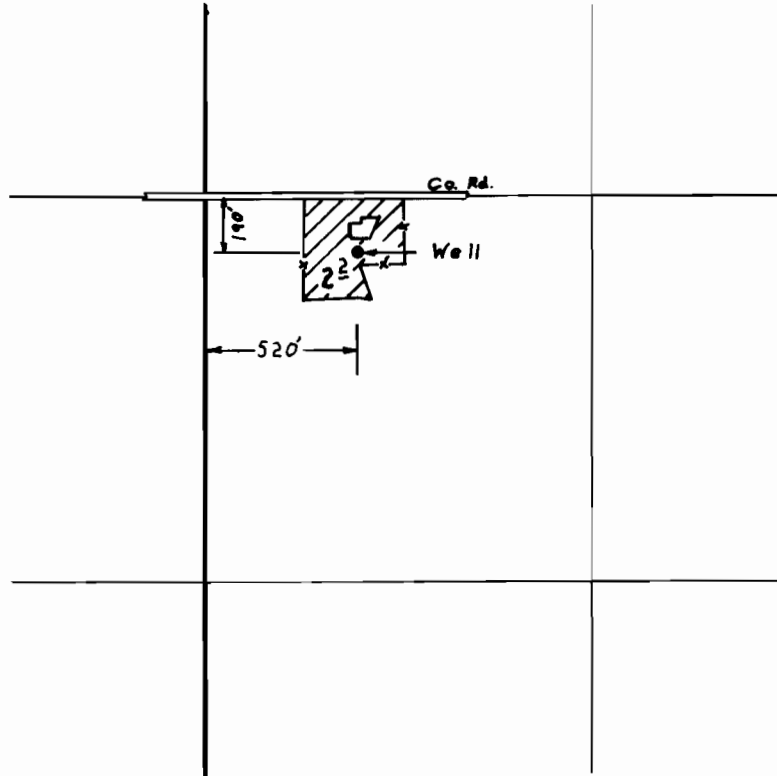

Scale : 1" = 660'

FINAL PROOF SURVEY UNDER

Application No. G-6188... Permit No. G-5863...
IN NAME OF

.....GLENN W. MIDDLETON.....

Surveyed AUG. 9. 1977, by B.R. SUND.....