

# T.1S. R.3W.,W.M.

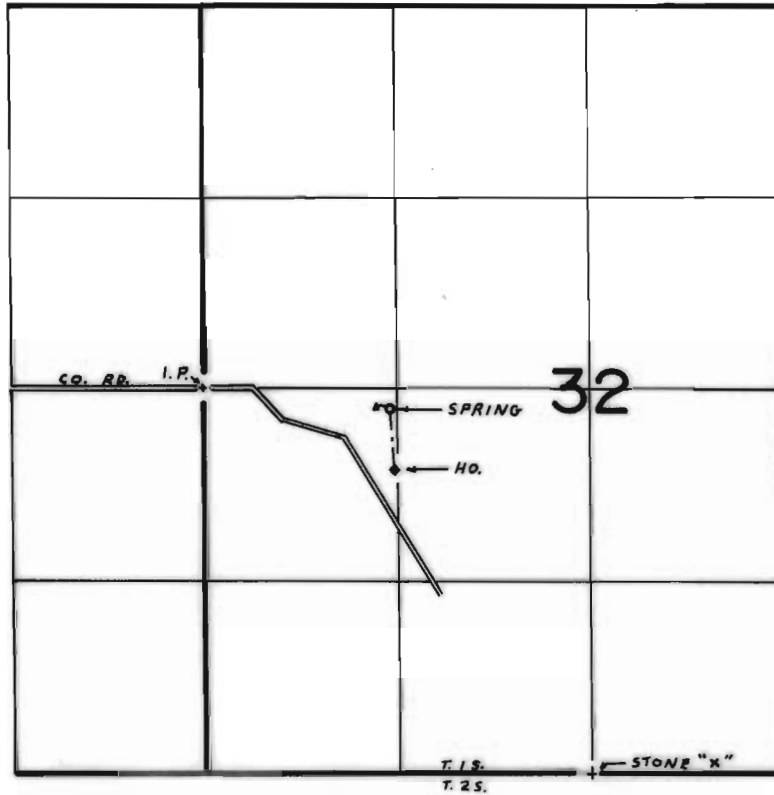

SPRING LOC. 1290' E. & 130' S. FROM W. 1/4 COR. SEC. 32

## FINAL PROOF SURVEY UNDER

Application No. 50849... Permit No. 38393...  
IN NAME OF

.....ERIC JAMES CANON.....

Surveyed MAY 3, 1977, by D.M. NORBY.....