

# T. 31 S., R. 4 W., W.M.

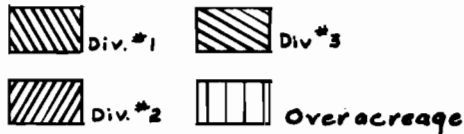
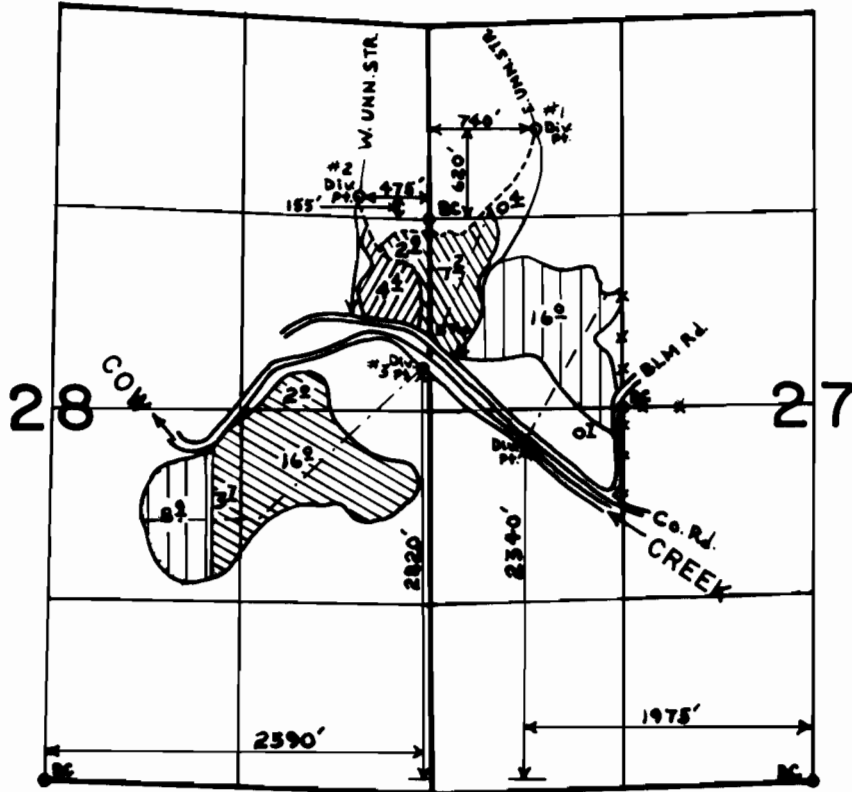

## FINAL PROOF SURVEY UNDER

Application No. 47155 Permit No. 35304  
IN NAME OF

GERALD S. & MARY LEE BRADY

Surveyed JULY 16 1976 by L.H. NUNN  
JULY 10 1978, by D.W. SPARKS