

G-1999

47714

T.36S. R.14E. W.M.

N. Fork Sprague River wells

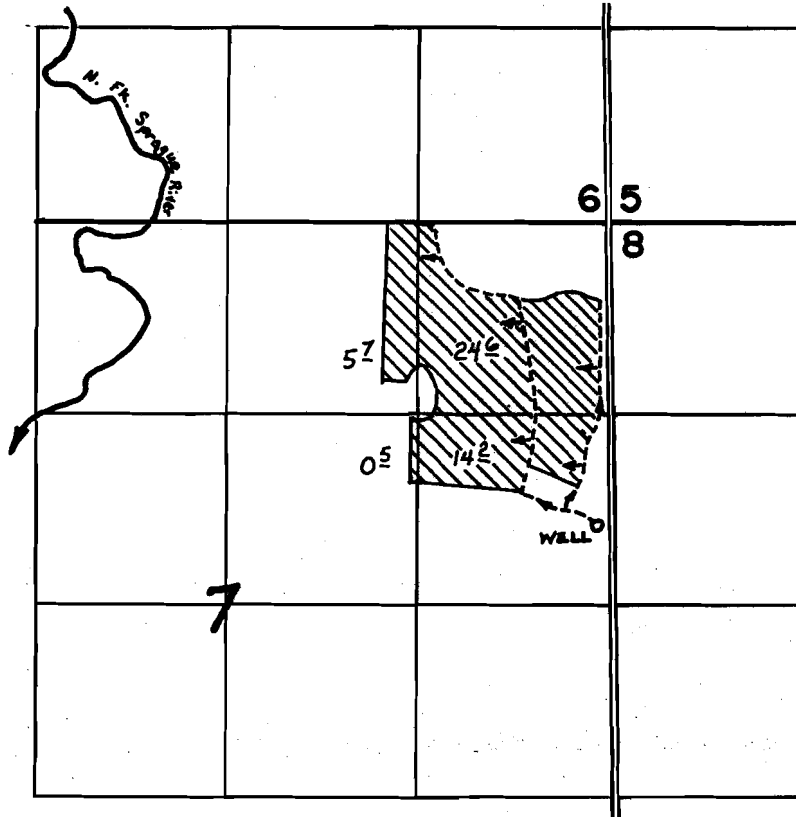

WELL LOCATED: 2075'S ± 100' W from the NE cor Sec. 7

FINAL PROOF SURVEY UNDER

Application No. G-2168. Permit No. G-1999.
IN NAME OF

..... J. F. ARROYO

Surveyed AUG. 22, 1977., by D. NORBY.....