

G-6583
47725

T.27S. R.17E., W.M.

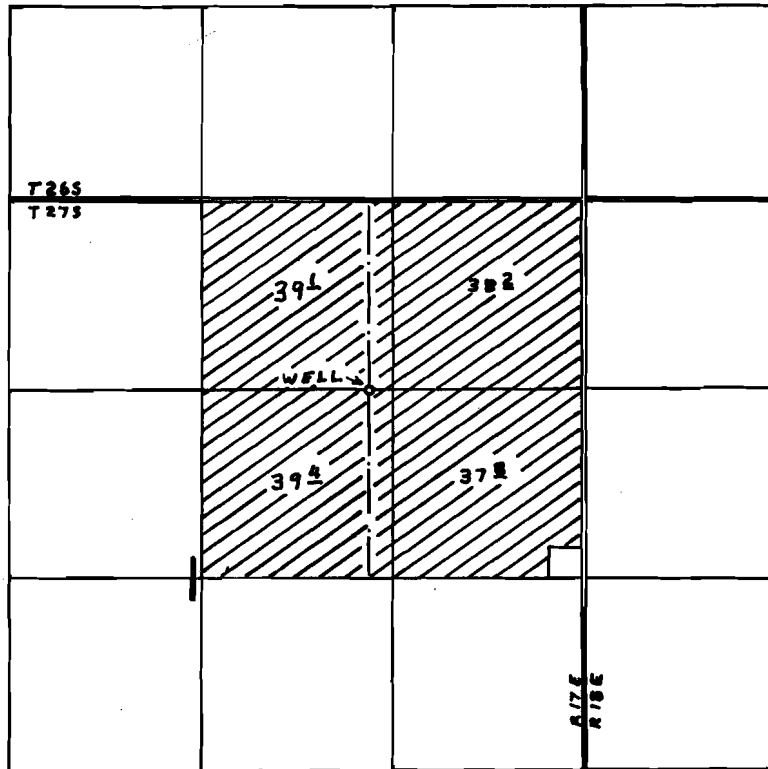

WELL Loc. 1300'S. & 1480'W. FROM N.E. COR. SEC. 1

FINAL PROOF SURVEY UNDER

Application No. G-7132.... Permit No. G-6583...
IN NAME OF

MELVIN D. & RAMONA HALL

Surveyed JUL. 19, 1977, by D.M. NORBY.....