

46-6159  
6-2924

T.18&2N.R.12&13E.W.M.

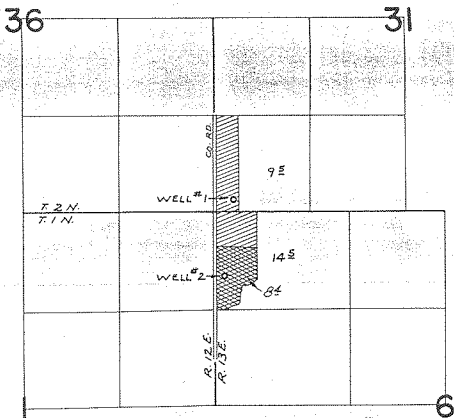

WELLS LOC: #1 - 170' N. & 260' E.; #2 - 870' S. & 130' E., BOTH FROM N.W. COR. SEC. 6

FINAL PROOF SURVEY  
UNDER

G-6556

G-6159

Application No. G-3226 Permit No. G-2924

IN NAME OF

ROBERT D. KRUEGER

Surveyed APR. 24, 1974, by D. NORBY.  
June 29, 77 - R.G. Muckan

R.G.M.  
572-9