

T.2S. R.1W., W.M.

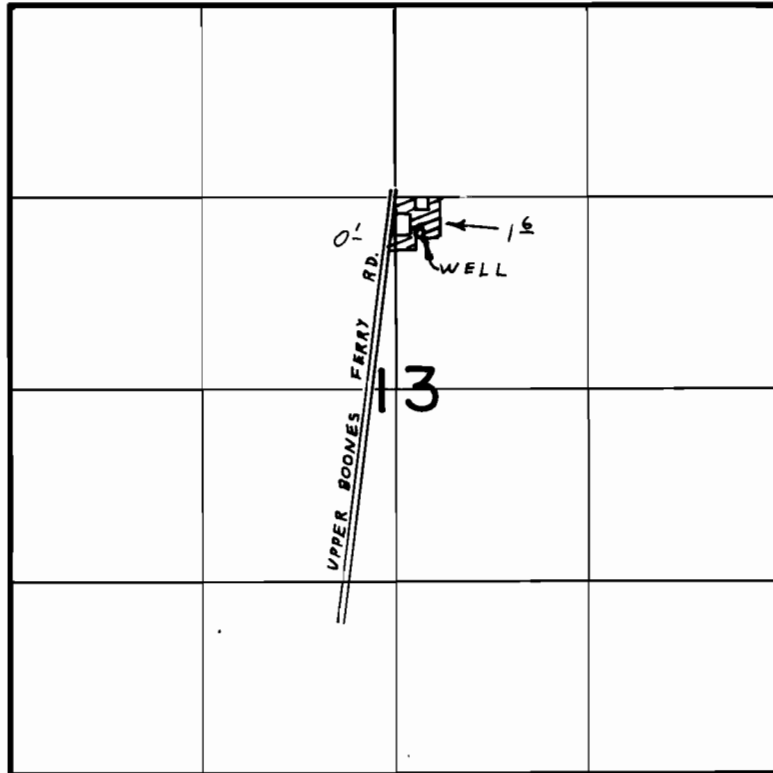

WELL LOC. 1080' N. & 170' E. C. $\frac{1}{4}$ COR. SEC. 13

FINAL PROOF SURVEY UNDER

Application No. G-7073. Permit No. G-6547.
IN NAME OF

RALPH A. SITTEL - SITTEL FUCHSIA GARDENS

Surveyed JUL. 8, 1977, by R. G. MUCKEN...