

T.4S.,R.4W.,W.M.

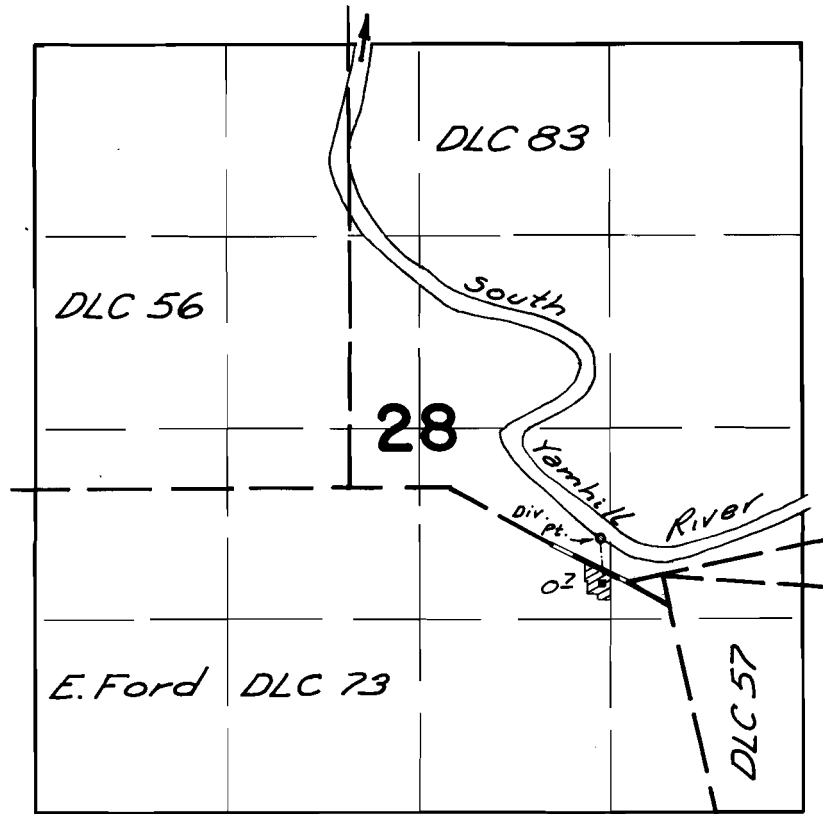

Div. Pt. Loc.: 760 H.S. & 1380 H.W. from E 1/4 Cor. Sec 28

FINAL PROOF SURVEY UNDER

Application No. 53230 Permit No. 39502
IN NAME OF

ROBERT M. JOHNSTONE

Surveyed June 3, 1976 by L. H. Nunn