

# T. 5 S. R. 3 E. W.M.

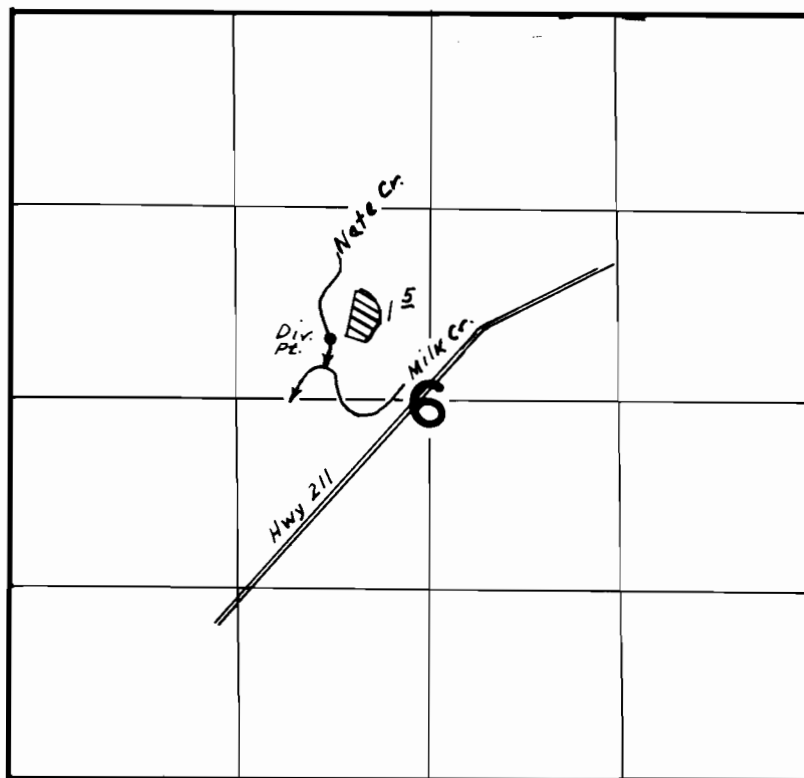

Div. Pt. Loc. 2250' S. & 3300' W. From NE Cor. Sec. 6

## FINAL PROOF SURVEY UNDER

Application No. 45852. Permit No. 34231...  
IN NAME OF

OREGON CONFERENCE OF THE UNITED CHURCH OF CHRIST

Surveyed May 3, 1978, by J.S. DONALDSON