

T.30S. R.15W. W.M.

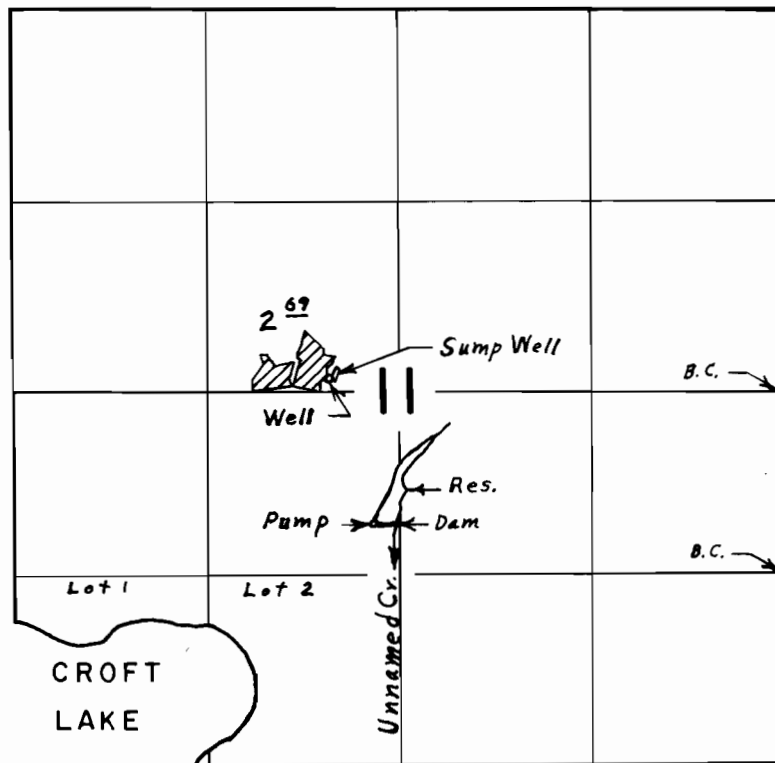

Div. Pts. located: Sump, 120' N. & 3060' W.; Well, 90' N. & 3100' W.; Res., 900' S. & 2670' W., all from E. $\frac{1}{4}$ Cor. Section 11

FINAL PROOF SURVEY UNDER

Application No. 52603 G-6739 Permit No. 39179 G-6265
IN NAME OF

ADOLPH MOLTHU

Surveyed Sept. 1., 1976. by L. E. Gould.