

RECEIVED

C 47791

JUN 24 1976

WATER RESOURCES DEPT  
SALEM, OREGON

SW1/4 SEC 29 T15S. R.12E.W.1M.  
DESCHUTES COUNTY

15 12 29C

1" = 400'

See Map 16 12 29B

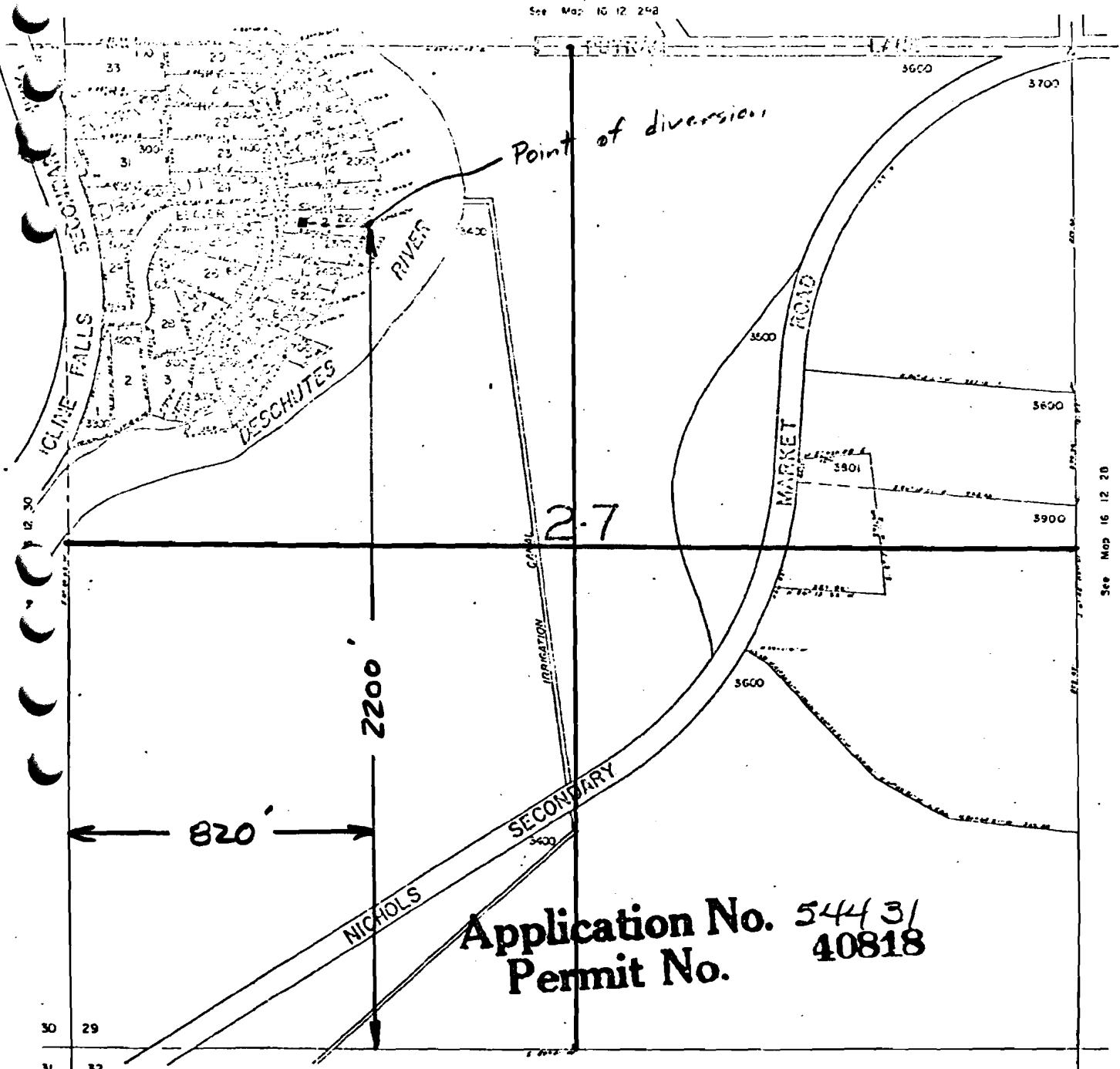

See Map 16 12 20

Application No. 54431  
Permit No. 40818

See Map 16 12 32

16 12 29C

P# 40818