

T. 33S. R. 6W. W.M.

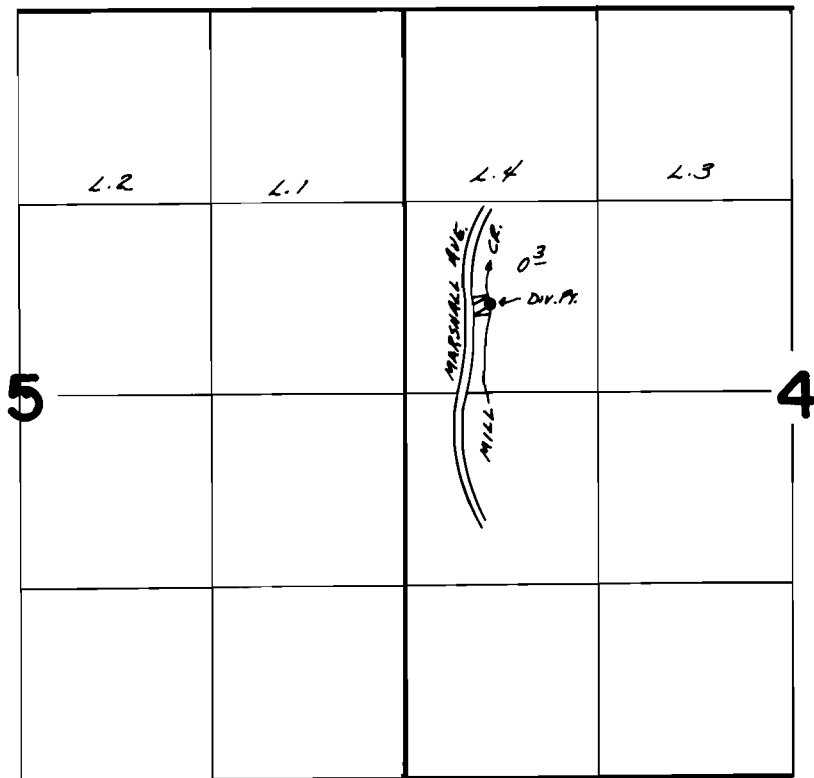

DIV. PT. LOC. - 600' N & 550' E From W 1/4 Cor. Sec. 4

FINAL PROOF SURVEY
UNDER

Application No. 50629 Permit No. 38257
IN NAME OF

.....MARY A. HARRIS.....

Surveyed April 27 1977, by D.M. NORBY.....