

T.22S. R.8W. WM.

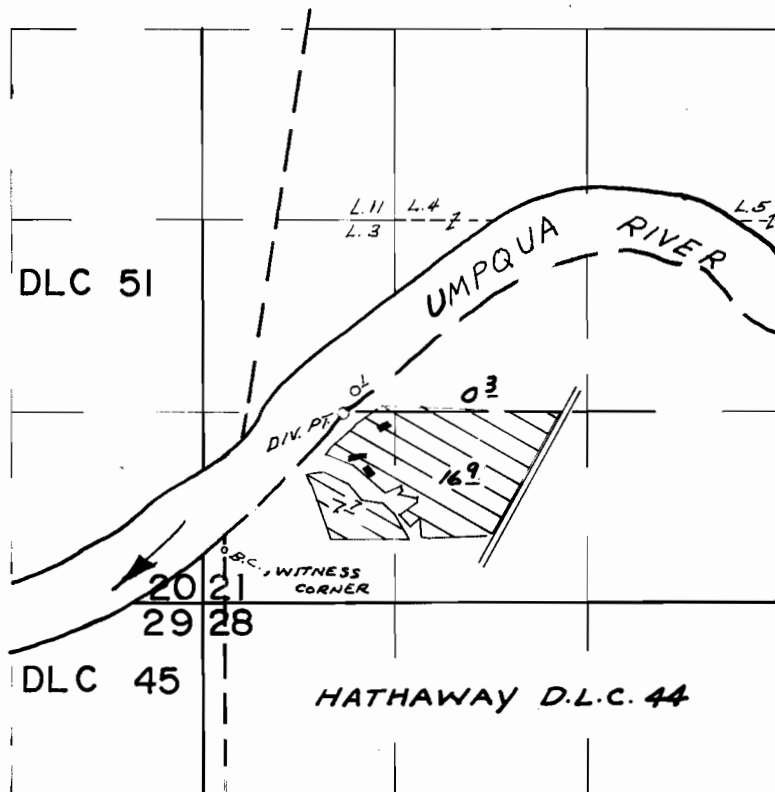

DIV. PT. LOC. 1300' N. & 980' E FROM TH SW COR. SEC. 21

FINAL PROOF SURVEY
UNDER

Application No. 51892... Permit No. 39054...
IN NAME OF

WILLIAM L. & HELEN R. RUFF

Surveyed APR. 21. 1977., by L.H. NUNN.....