

T. 11S. R. 2W. W.M.

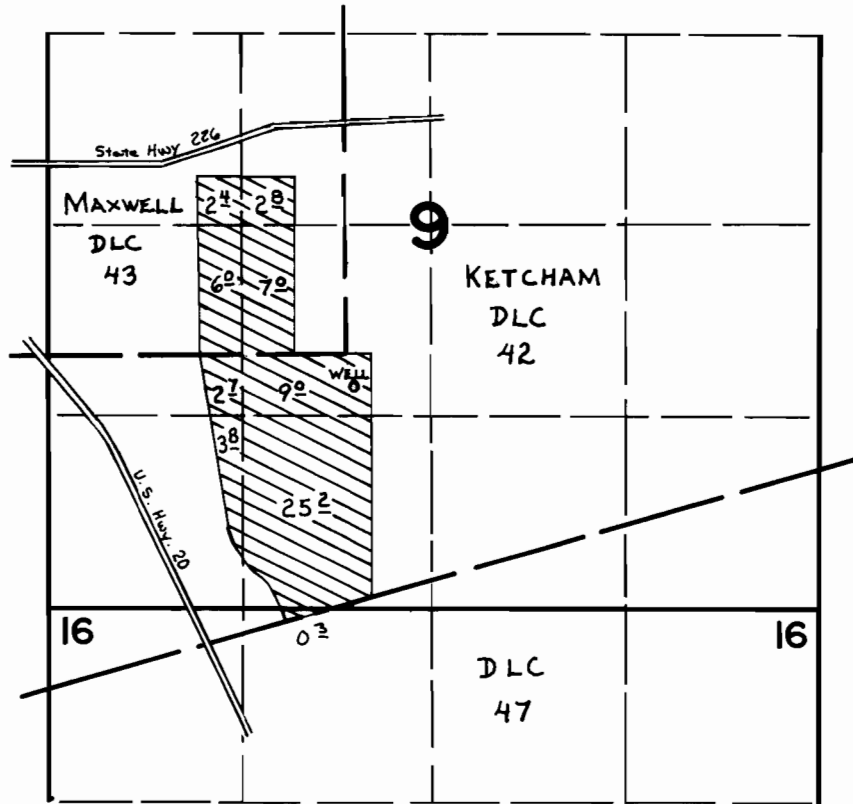

Div. Pt. Located: 250' S & 70' E from Easterly SE cor.
Maxwell DLC 43

FINAL PROOF SURVEY UNDER

Application No. G-6873 Permit No. G-5679
IN NAME OF

ROBERT MERCER

Surveyed AUG. 10. 1977., by D. NORBY