

# T.6S. R.2W. W.M.

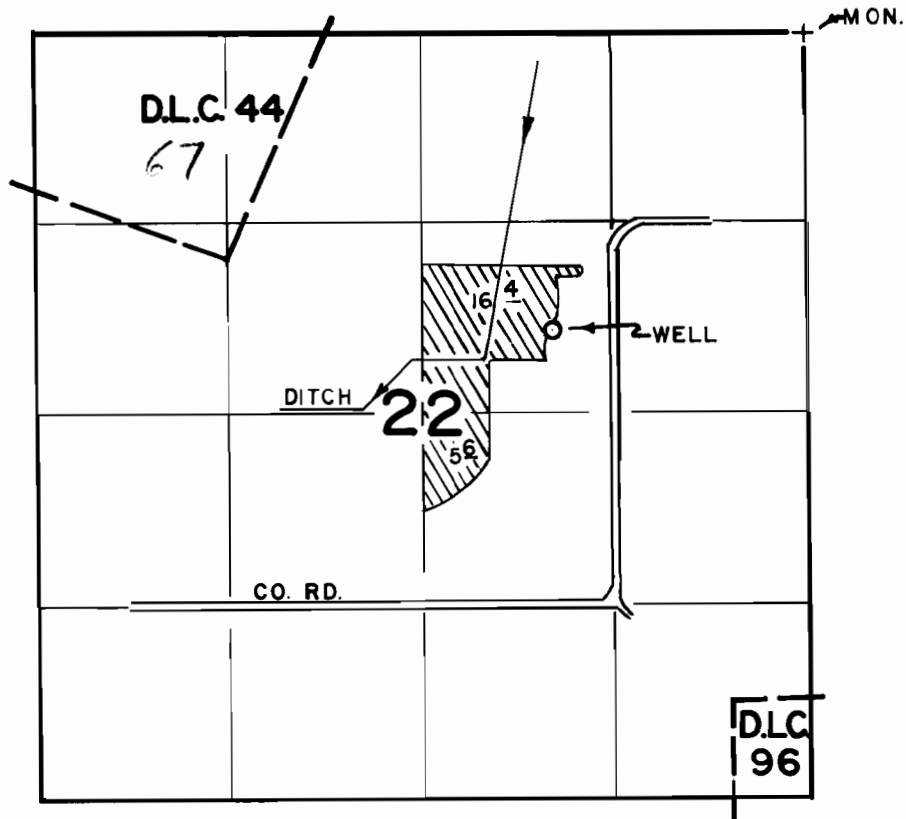

WELL LOC: 2050'S. & 1750' W. FROM N.E. COR. SEC. 22

## FINAL PROOF SURVEY UNDER

Application No. G-6761... Permit No. G-6281...  
IN NAME OF

KURTH FARMS INC.

Surveyed AUG. 8... 19.77, by BRUCE R. SUND.