

T.6S. R.2W. W.M.

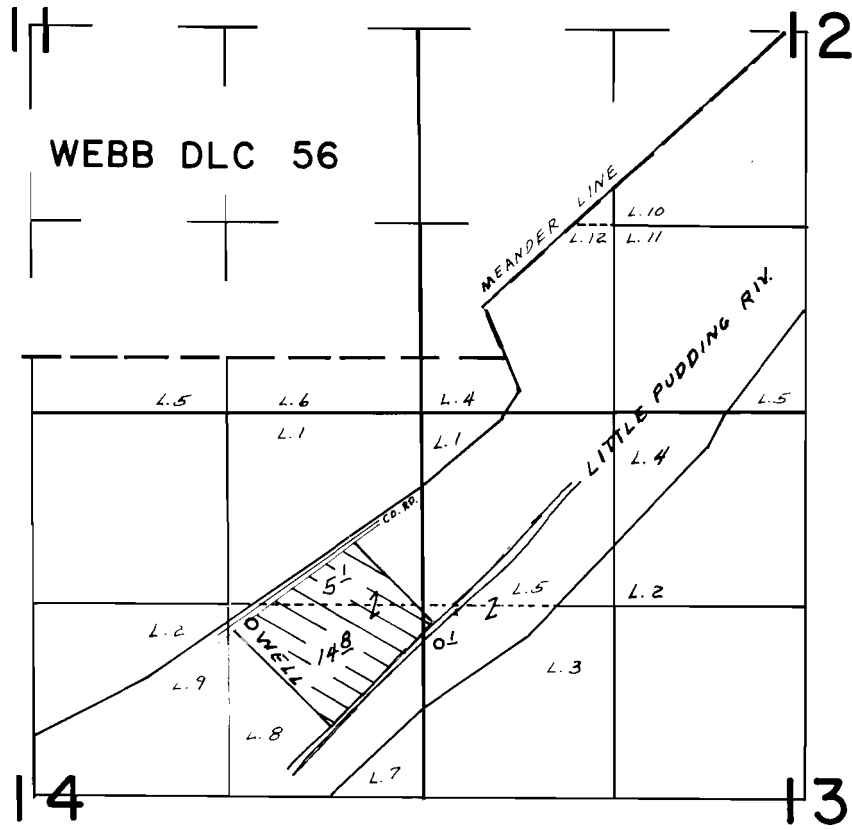

WELL LOG. 1450'S. & 1160'W. FROM THE NE COR. SEC. 14

FINAL PROOF SURVEY UNDER

Application No. G-6964.. Permit No. G-6476..
IN NAME OF

RICHARD D. HARRIS

Surveyed APR. 15. 1977., by L.H. NUNN.....