

T.1S. R.9W. W.M.

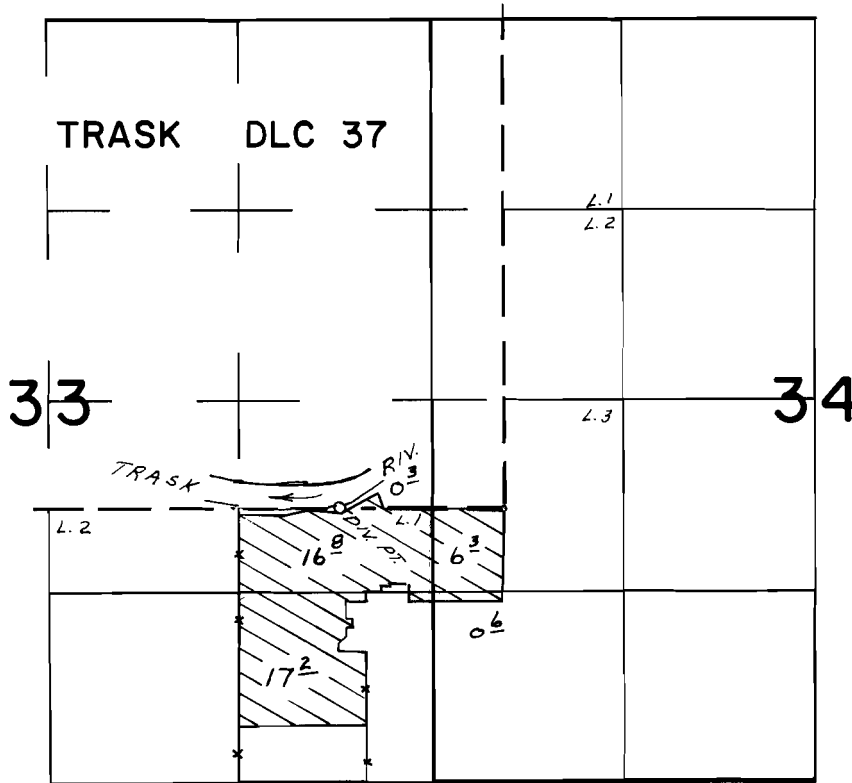

DIV. PT. LOC. 1120' W FROM SE COR TRASK DLC 37

**FINAL PROOF SURVEY**  
UNDER

Application No. 44432... Permit No. 33340...  
IN NAME OF

.....**WILLIAM TIPPIN**.....

Surveyed AUG. 1..... 1977., by L.H. NUNN.....