

T. 4N. R. 38E. W.M.

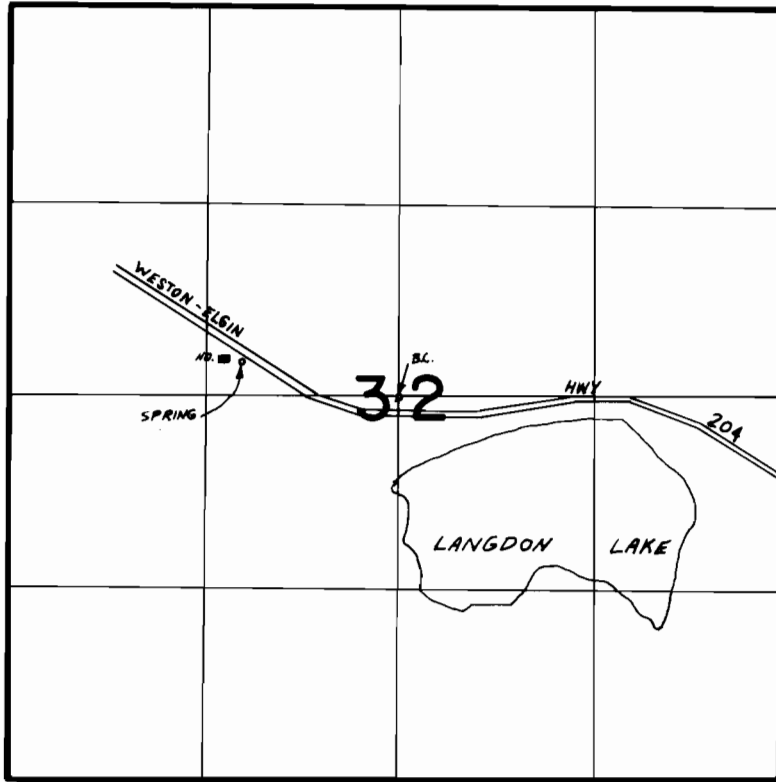

SPRING LOC. 1070'W & 230'N FROM CENTER SEC 32

**FINAL PROOF SURVEY**  
UNDER

Application No. 54614..... Permit No. 40979.....  
IN NAME OF

**C. R. SCHUBERT**

Surveyed 10-17 1977, by R. BARWIN