

P # 41020

T.4&5S. R.12E. W.M.

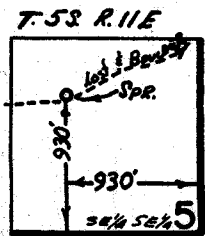
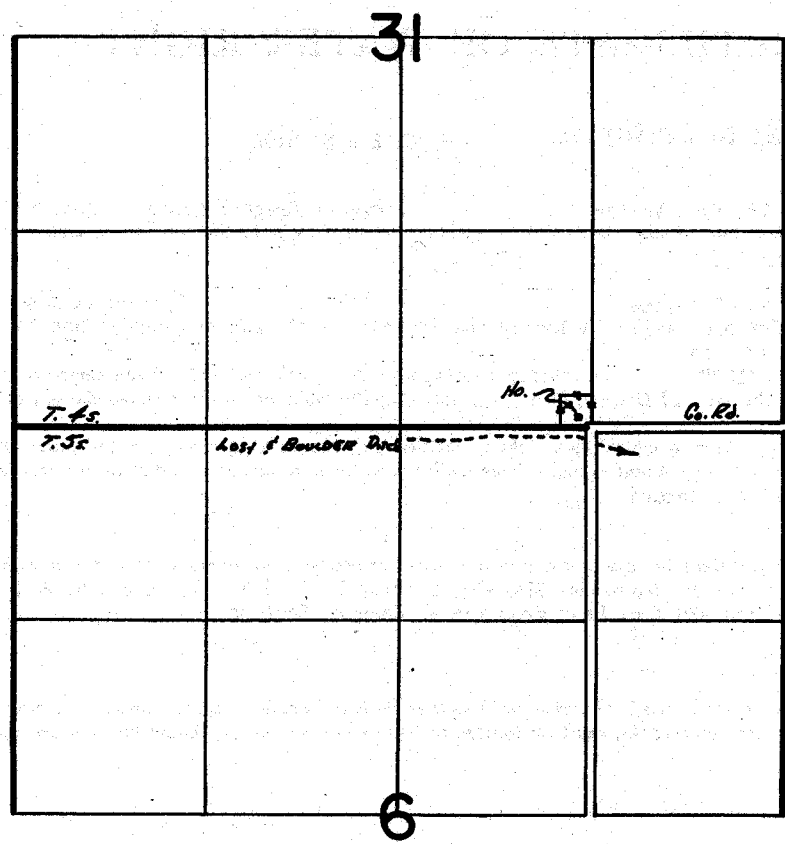

Application Map For

W. C. & ELMA HYDE

Scale 4" = 1mile

Application No. 54671
 Permit No. 41020

RECEIVED

196161976

WATER RESOURCE DEPT
 SALEM, OREGON

Application Map Prepared By
 Watermaster District No. 3
 Thomas J. Paul