

# T.1S.R.4W., W.M.

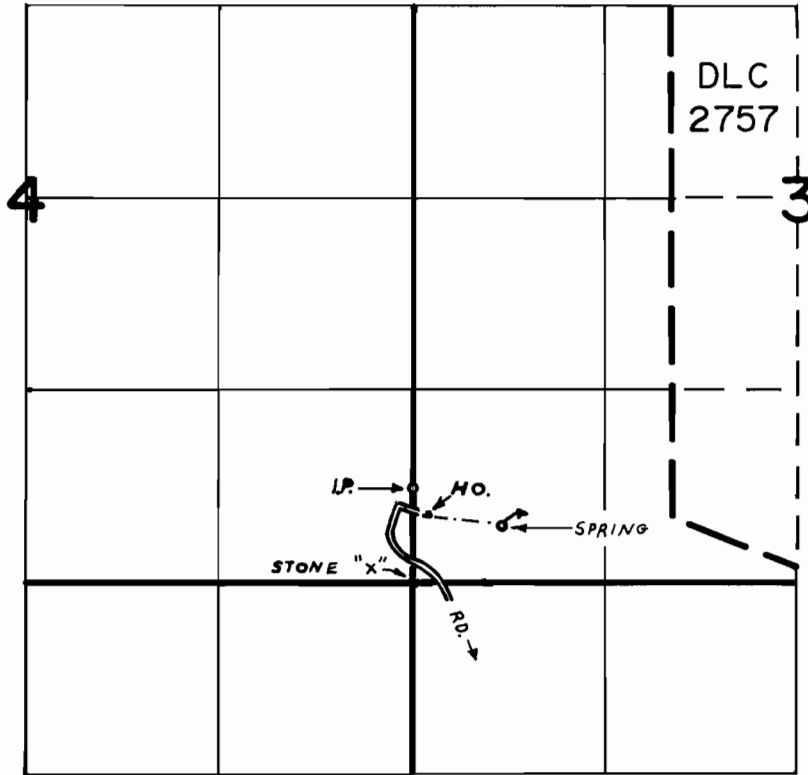

SPRING LOC. 390' N. & 610' E. FROM S.W. COR. SEC. 9

## FINAL PROOF SURVEY UNDER

Application No. 51781..... Permit No. 39011.....  
IN NAME OF

..... *LARRY R. ADAMS* .....

Surveyed NOV. 8, 1977, by R.G. MUCKEN.....