

T.5S. R.1E. W.M.

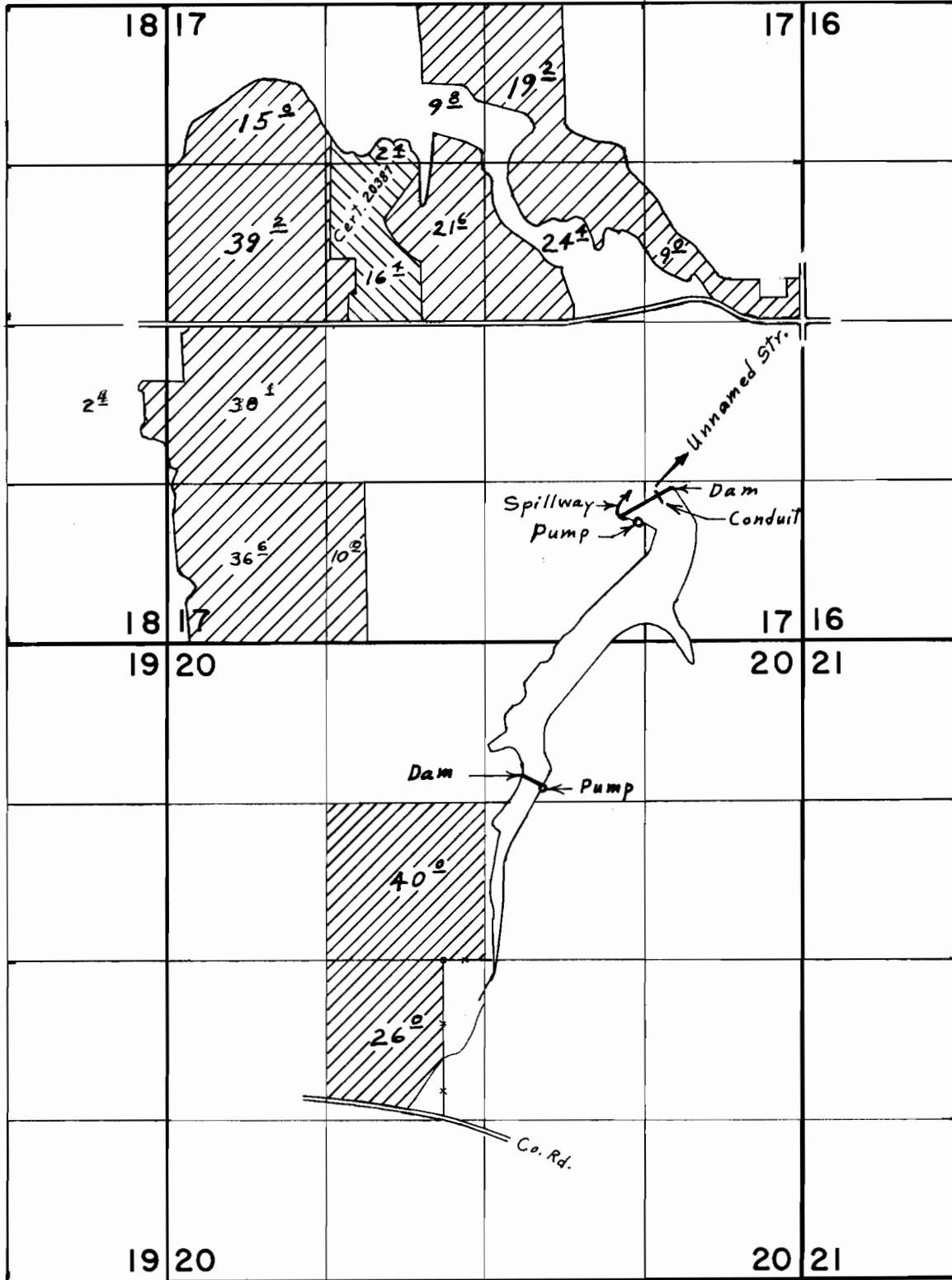

Div. Pt. located 1220' N. & 1220' W. from S.E. Corner Section 17.

Primary
Supplemental



FINAL PROOF SURVEY

UNDER

Application No. 52641 Permit No. 39823

IN NAME OF
BILL L. ROSE

Surveyed Sept. 9, 1976, by L. E. Gould