

T-4125

T. 4 & 5 S. R. 1 W. W.M.

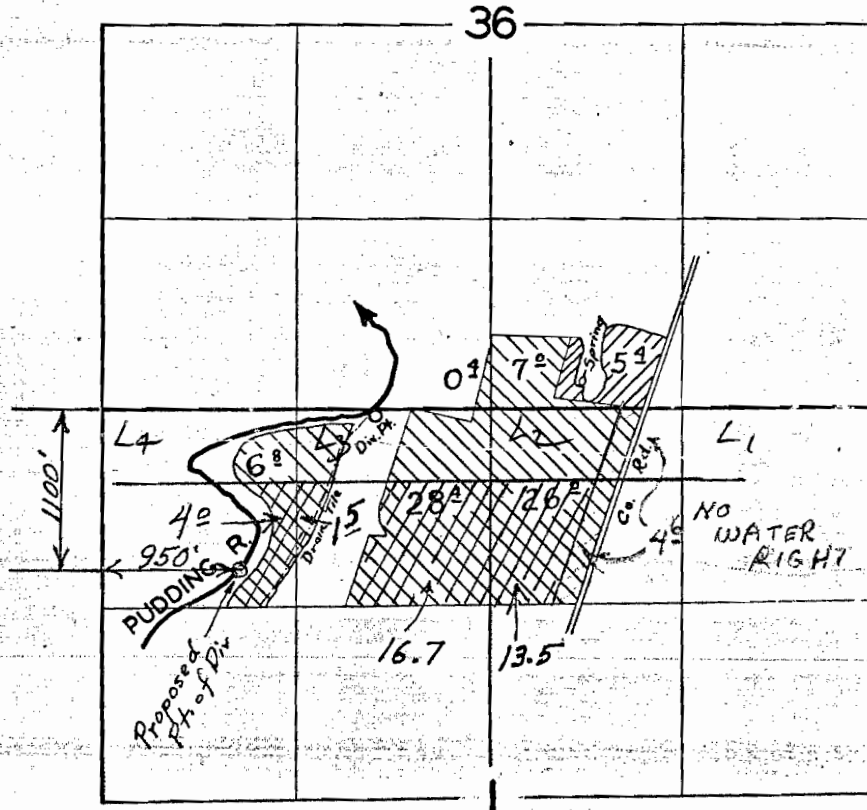

1060 S  
1630 W  
N 2 S 1

 Lands to be irrigated from Proposed Pt. of Div.

### FINAL PROOF SURVEY

UNDER

Application No. 26601. Permit No. 20836

IN NAME OF

MERLE TRACHAEL

Surveyed 7 MAR. 1956, by R.D. BEST

DFK-2D-79

BEST