

T.24S.R.32 1/2 E.W.M.

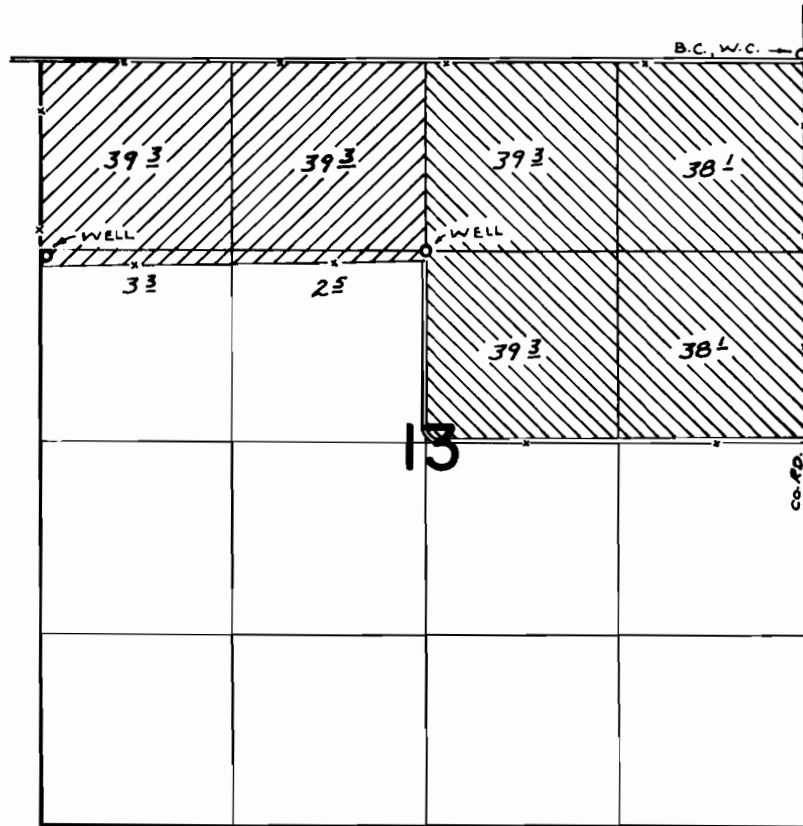

G-4125 EAST WELL - AT S.W. COR. N.W. 1/4 NE 1/4 SEC. 13
 G-6802 WEST WELL - 1370'S. & 40'E. FROM N.W. COR. SEC. 13

FINAL PROOF SURVEY UNDER

Application No. ~~G-6802~~ ^{G-4125} Permit No. ~~G-6849~~ ^{G-3948} 
 IN NAME OF

.....IRVIN P. SCHOUVILLER.....

Surveyed AUG. 18, 1976, by R. MUCKEN