

# T.24S.R.32 1/2 E.W.M.

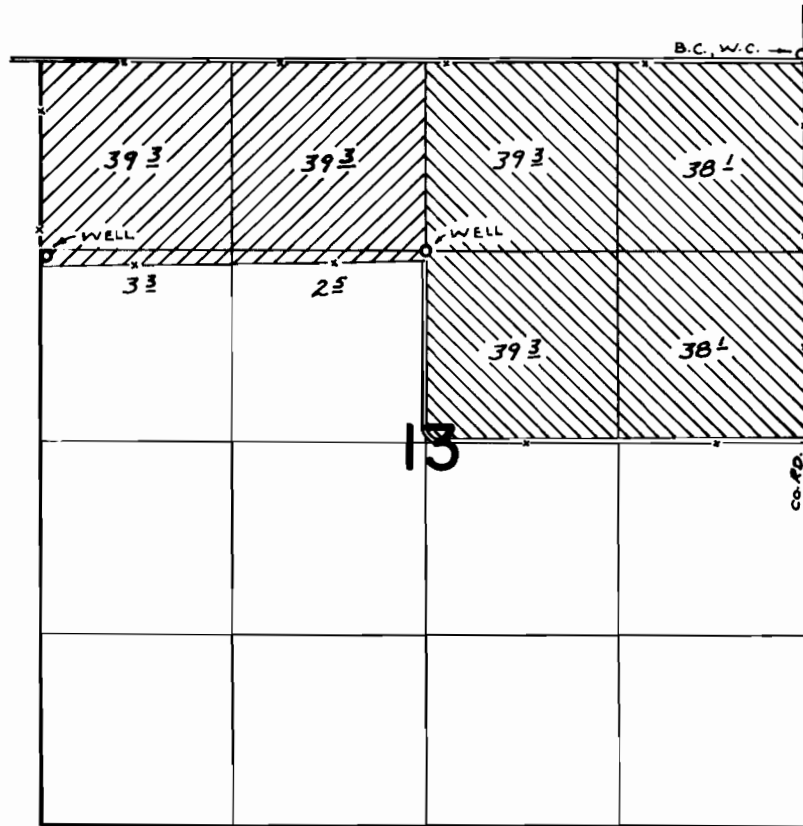

G-4125 EAST WELL - AT S.W. COR. N.W. 1/4 NE 1/4 SEC. 13  
 G-6802 WEST WELL - 1370'S. & 40'E. FROM N.W. COR. SEC. 13

## FINAL PROOF SURVEY UNDER

Application No. ~~G-6802~~ <sup>G-4125</sup> Permit No. ~~G-6849~~ <sup>G-3948</sup>   
 IN NAME OF

..... IRVIN P. SCHOUVILLER .....

Surveyed AUG. 18, 1976, by R. MUCKEN