

# T.1S.,R.3E.,W.M.

SE1/4NE1/4 Sec. 22

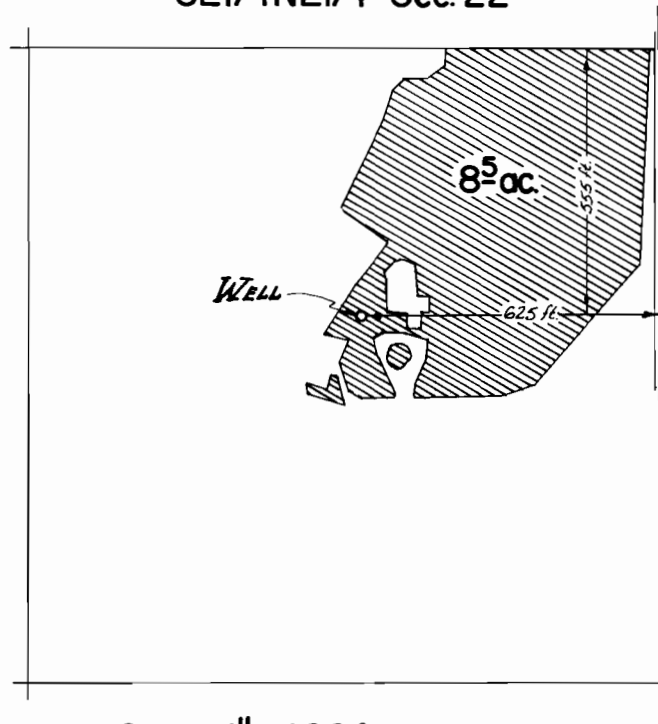

Scale: 1" = 400 ft.

## FINAL PROOF SURVEY UNDER

Application No. G-6370 Permit No. G-5965  
IN NAME OF

FRANK L. NEWELL, Jr.

Surveyed Aug. 10 1976, by L. E. Gould