

# T. 5S., R. 4W., W.M.

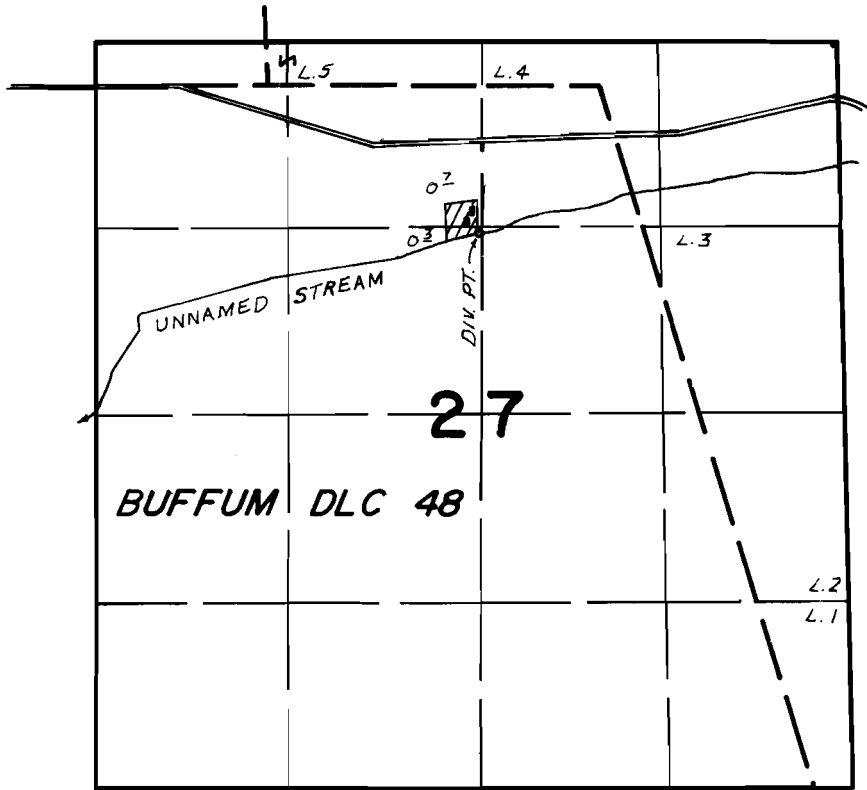

DIV. PT. LOC. 1300'S. & 30' W. FROM N. 1/4 COR. SEC. 27

## FINAL PROOF SURVEY UNDER

Application No. 53153... Permit No. 400.44...  
IN NAME OF

ARTHUR A. & FLORENCE A. GUTHRIE

Surveyed AUG. 10. 1977, by L.H. NUNN.....