

T. 6S., R. 3W., W. M.

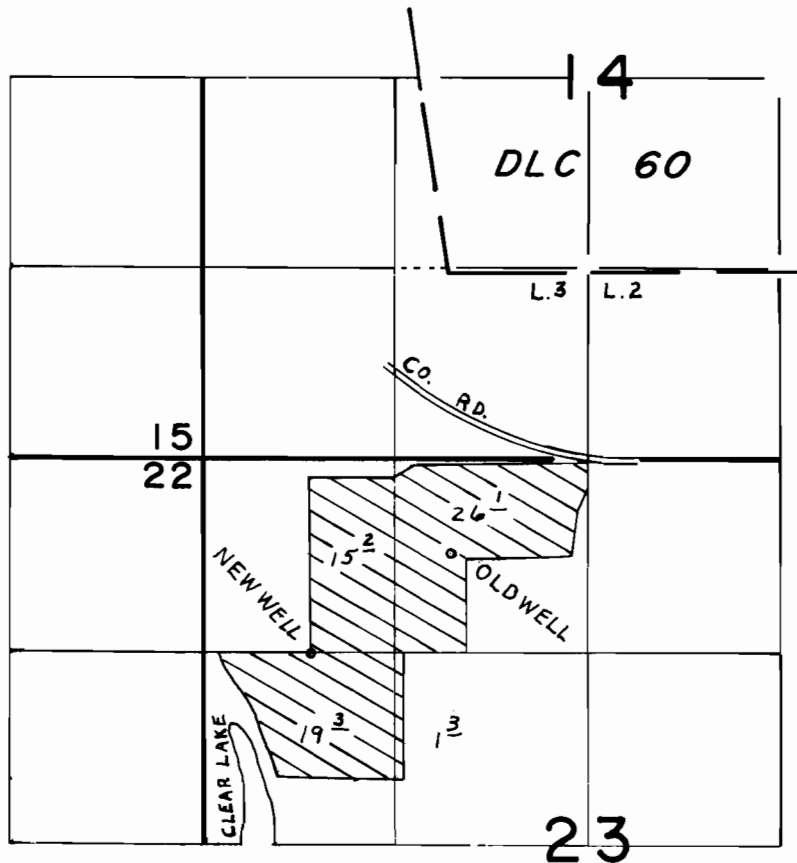

NEW WELL LOC. 1320'S. & 1910'W. FROM N. 1/4 COR. SEC. 23

**FINAL PROOF SURVEY**  
UNDER

Application No. G-7187 Permit No. G-6702  
IN NAME OF

BRUCE R. CHAPIN

Surveyed APR. 15 1977, by L.H. NUNN