

# T.31S. R.4W., W.M.

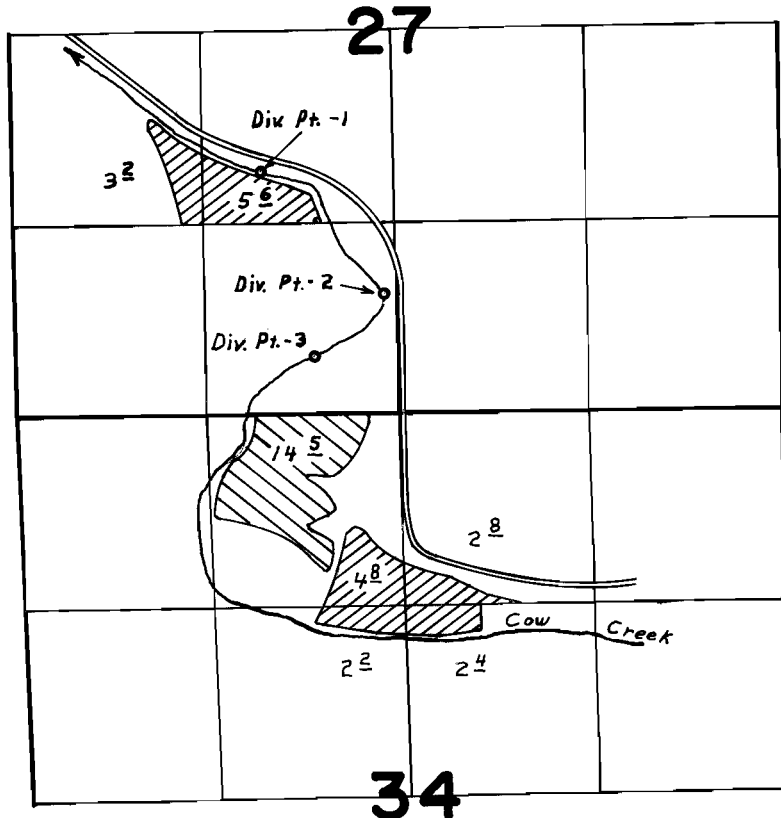

Div. Pts. Loc.  $\left. \begin{array}{l} 1 - 1670'N. \& 950'W. \\ 3 - 390'N. \& 590'W. \end{array} \right\} \text{Both From } S\frac{1}{4} \text{ Cor. Sec. 27}$

 APP. - 49262

## FINAL PROOF SURVEY UNDER

 Transfer No. 2646

Transfer No. 2646  
Application No. 49262.. Permit No. 36922..  
IN NAME OF

.....ROBERT SANDERS.....

Surveyed APR...28 1977, by D.M. NORBY.....